



Date: Monday, 8th August, 2016 at 13:00

Venue: Jim Cooke Conference Suite, Stockton Central Library, Stockton on
Tees, TS18 1TU

Cllr David Wilburn(Chairman)
Cllr Tracey Stott(Vice-Chairman)

Cllr Derrick Brown
Cllr Philip Dennis
Cllr Ross Patterson

Cllr Evaline Cunningham
Cllr Elsi Hampton

AGENDA

1 Evacuation Procedure

Procedure attached [Page 1]

2 Apologies for absence

3 Declarations of Interest

**4 Minutes from the meeting which was held on the 2nd
December 2015.**

For approval and signature.

Minutes attached.....[Page 3]

5 Procedure

Procedure 24K/bytes attached.....[Page 9]

6 Proposed Traffic Regulation Order - Goose Pasture.Yarm

Report 126K/bytes attached.....[Page 11]

Appendix 1 561K/bytes attached.....[Page 21]

Appendix 2 258K/bytes attached.....[Page 23]

Appendix 3 26M/bytes attached.....[Page 25]

* Exempt Item



Members of the Public - Rights to Attend Meeting

With the exception of any item identified above as containing exempt or confidential information under the Local Government Act 1972 Section 100A(4), members of the public are entitled to attend this meeting and/or have access to the agenda papers.

Persons wishing to obtain any further information on this meeting, including the opportunities available for any member of the public to speak at the meeting; or for details of access to the meeting for disabled people, please

Contact: Michael Henderson Tel 01642 528173 or email michael.henderson@stockton.gov.uk

Members' Interests

Members (including co-opted Members) should consider whether they have a personal interest in any item, as defined in paragraphs 9 and 11 of the Council's code of conduct and, if so, declare the existence and nature of that interest in accordance with and/or taking account of **paragraphs 12 - 17** of the code.

Where a Member regards him/herself as having a personal interest, as described in **paragraph 16** of the code, in any business of the Council he/she must then, **in accordance with paragraph 18** of the code, consider whether that interest is one which a member of the public, with knowledge of the relevant facts, would reasonably regard as so significant that it is likely to prejudice the Member's judgement of the public interest and the business:-

- affects the Member's financial position or the financial position of a person or body described in **paragraph 17** of the code, or
- relates to the determining of any approval, consent, licence, permission or registration in relation to the Member or any person described in **paragraph 17** of the code.

A Member with a personal interest, as described in **paragraph 18** of the code, may attend the meeting but must not take part in the consideration and voting upon the relevant item of business. However, a Member with such an interest may make representations, answer questions or give evidence relating to that business before the business is considered or voted on, provided the public are also allowed to attend the meeting for the same purpose whether under a statutory right or otherwise (**paragraph 19** of the code).

Members may participate in any discussion and vote on a matter in which they have an interest, as described in **paragraph 18** of the code, where that interest relates to functions of the Council detailed in **paragraph 20** of the code.

Disclosable Pecuniary Interests

It is a criminal offence for a Member to participate in any discussion or vote on a matter in which he/she has a disclosable pecuniary interest (and where an appropriate dispensation has not been granted) (**paragraph 21** of the code).

Members are required to comply with any procedural rule adopted by the Council which requires a Member to leave the meeting room whilst the meeting is discussing a matter in which that Member has a



Stockton-on-Tees

**Appeals & Complaints
Committee**

BOROUGH COUNCIL

Agenda

www.stockton.gov.uk

disclosable pecuniary interest (**paragraph 22** of the code).

Jim Cooke Conference Suite, Stockton Central Library

If the fire or bomb alarm should sound please exit by the nearest emergency exit. The Fire alarm is a continuous ring and the Bomb alarm is the same as the fire alarm however it is an intermittent ring.

If the Fire Alarm rings exit through the nearest available emergency exit and form up in Municipal Buildings Car Park.

The assembly point for everyone if the Bomb alarm is sounded is the car park at the rear of Splash on Church Road.

The emergency exits are located via the doors between the 2 projector screens. The key coded emergency exit door will automatically disengage when the alarm sounds.

The Toilets are located on the Ground floor corridor of Municipal Buildings next to the emergency exit. Both the ladies and gents toilets are located on the right hand side.

Appeals & Complaints Committee

A meeting of Appeals & Complaints Committee was held on Wednesday, 2nd December, 2015.

Present: Cllr David Wilburn(Chairman), Cllr Sonia Bailey(Sub Cllr Tracey Stott), Cllr Derrick Brown, Cllr Evaline Cunningham, Cllr Maurice Perry(Sub Cllr Philip Dennis), Cllr Elsi Hampton, Cllr Ross Patterson

Officers: Mark Gillson(DNS), Julie Butcher, Sarah Whaley(LD)

Also in attendance:

Apologies: Cllr Phil Dennis, Cllr Tracey Stott

**ACC
6/15** **Evacuation Procedure**

The Evacuation Procedure was noted.

**ACC
7/15** **Declarations of Interest**

There were no declarations s of interest.

**ACC
8/15** **Procedure**

The Committee considered and agreed a proposed procedure for the meeting, which the Chairman explained ahead of the following item.

RESOLVED that the procedure be agreed.

**ACC
9/15** **Minutes from the meeting which was held on the 17th July 2015.**

Consideration was given to the minutes from the meeting which was held on the 17th July 2015 for approval and signature.

RESOLVED that the minutes be approved and signed as a correct record by the Chairman.

**ACC
10/15** **Proposed Parking Restrictions - High Street, Norton**

Members were provided with a report relating to outstanding objections' received, following statutory advertising of a Traffic Regulation Order for proposed parking restrictions in High Street and Harland Place, Norton.

An Officer from Economic Growth and Development Services was in attendance and presented the report.

Members were provided with background information and it was explained that in 2011 a Borough wide parking study was undertaken. Norton was identified

as an area for assessment. The Central Area Transport Strategy (ATS) Group whose members were local transport stakeholders had been given an annual budget allocation to spend on transport priorities in their particular area. Stakeholders included Ward Councillors and Norton Village Residents Association. The Central ATS Group approved a study into parking in Norton given the perceived parking issues in the area and to investigate the feasibility of introducing pedestrian crossing facilities at Leven Road.

Information received from Norton Village Residents Association (NVRA) demonstrated that the main concern was obstructive and indiscriminate parking for both residents and businesses. Introducing limited waiting and no waiting restrictions that could be enforced could reduce the impact of such parking.

On-street parking surveys had been undertaken which indicated that there was high use and turnover throughout the day along the east and west side of the High Street carriageway. Three areas had been identified as potential 2 hour limited waiting areas:

- The existing car park close to the amenities, adjacent to 4-10 High Street;
- The uncontrolled area adjacent to 8-12 Harland Place;
- An increase to the duration of stay to 2 hours in Leven Road was proposed to allow a more consistent approach.

It was also proposed to formalise the Keep Clear restriction on the west side service road (Fox Alms Houses) to no waiting at anytime restrictions, to allow regular access and stop obstructive parking.

An exhibition and drop in session was carried out in Norton Library. The drop in session was well attended. It was noted that there had been 91% in support of the 2 hour limited waiting on the High Street and 85% in support of the 2 hour limited waiting at Harland Place. A full summary of the results were contained within the main report.

As a result of the exhibition and drop in session the following suggestions were made and had been incorporated into the scheme as follows:

- Introduce an evening Taxi Rank in the west side service road from 47 to 53 High Street the proposed operating times would be 8pm to 4am.
- A bollard to be installed at the puffin crossing next to Norton Fisheries.
- Additional Keep Clear markings and hatching to assist vehicles exiting service roads along the length of the High Street.

Authorisation to advertise the proposed Traffic Regulation Order in Norton High Street as per drawing TM14/124 in Appendix 1 of the report was subsequently given in June 2014 (decision record TS.T.38.14).

Statutory advertising ran from 8 July 2015 until 5 August 2015 during which time the Council formally received 3 objections opposed to the 2 hour Limited Waiting on parking in the existing car park adjacent to 4-10 High Street and from 8-10 Harland Place. Copies of all correspondence exchanged was provided.

A copy of the objection letters were contained alongside the main report from Ms Duell, Ms Clancy and Mrs Smith. The letters and draft report were presented to the Head of Economic Growth & Development Services and Cabinet Member for Regeneration and Transport at their de-brief meeting on 15 October 2015.

A summary of the objections and response from the Head of Economic Growth and Development services was set out at Appendix 5 of the report as seen by Members.

The Objectors were not in attendance at the meeting to make representation to the Committee, however further correspondence had been received from Ms Duell, the detail of which was provided to Members for consideration.

The police and emergency services had no objections to the proposals. Local Ward Councilors' had previously been consulted and no formal comments had been received. Scheme approval had been given by the Head of Economic Growth and Development Services in consultation with the Cabinet Member for Regeneration and Transport.

The Committee, in the presence of Officers from Law and Democracy, considered its decision taking into account all of the written information within the report and that which was provided at the meeting. Their comments could be summarised as follows:

- Concerns were raised regarding the displacement of parking to nearby residential streets. The Principal Engineer explained to Members that the proposals would be introduced in 3 phases. If there was evidence that there was issues with Long Stay parking in residential areas then this could be looked at and if required the appropriate action would be taken.
- Members discussed whether any local residents would be affected by the new scheme. It was explained that although there were residents living above Harland Place no formal objections had been received.
- Brief discussion took place around the changes which were to take place

close to café Lilli which comprised of clearer marking and hatching to define car parking spaces. No additional restrictions were to be imposed.

- It was confirmed that the main body of the high street would not be affected.

- Clarity was sought as to whether the service road close to the local Tesco store would be affected by the 2 hour restriction. Officers confirmed that this was subject to 2 hour limited waiting and was marked and plated as such.

- Members went on to discuss the newly proposed taxi rank which had been added as a result of the consultation exercise. The Evening economy had taken off in Norton and it was clear that there was a demand for a taxi rank, although this had yet to be established. The operating hours would be from 8.00pm until 4.00am. The rank was still available for parking outside of the operating hours with a 2 hour restriction.

- It was confirmed that 25 spaces would be affected by the 2 hour waiting restrictions however there was evidence which indicated that some of these spaces were being used for 7 hours or more by individual car owners. Members commented that as parking was a scarce resource in Norton it was not fair that some people were using the spaces for such a long time.

- Members briefly considered if anything could be done about the positioning of some of the bays in the High Street. Some cars were so big that they overhung the pavements making it difficult for pedestrians. Likewise some vehicles were overhanging the highway making it difficult for traffic to pass, especially buses. Members queried whether the bays could be re marked at an angle to try to eliminate the hangover problems however it was explained that getting in and out of the spaces could present a worse problem. A request was made to confirm that the carriageway was at least 6.7 metres wide.

- Officers informed the Committee that the High Street was in a conservation area and due to the historical situation, where parking was concerned, Officers had tried to make the best of the situation. If vehicles were parked beyond the extent of the marked bays then this could be looked at.

- Members asked if consideration could be given to turning the bays so the cars parked end to end. It was explained that if this was introduced then a large number of spaces would be lost. This issue was not part of the proposed order but Officers agreed to look at it.

- Comparisons were made to Yarm High Street where a recent pay and display scheme had been introduced and which had proved to be extremely successful for local businesses. The scheme had enabled more parking spaces to become frequently available during the day. Prior to the scheme more than 60% of the spaces were occupied for most of the working day making it difficult

for shoppers. It was felt that the same principles should be transferred to Norton with the hope it too benefitted from the same success.

- The consultation had received overwhelming support and all objections received had been addressed.

RESOLVED that:

1) The Head of Economic Growth and Development be recommended not to uphold the objection.

2) Local Ward Councillors, Norton Village Residents Association and the objectors be informed of the Committee's recommendation.

AGENDA NO

APPEALS AND COMPLAINTS COMMITTEE PROCEDURE FOR MEETING

1. The objectors, any supporters and officers representing the Council will be in attendance from the commencement of the item.
2. The Chairman will introduce the Committee and will explain that it is meeting to hear representations from relevant parties and to come to a decision based on the facts of the case.
3. The Chairman will refer to the procedure as detailed below.
 - i. An officer will introduce the matter and present their report.
 - ii. The complainant will be given the opportunity of presenting their case
 - iii. Members of the Committee and other parties will be given the opportunity to ask questions at i and ii above
 - iv. The complainant and officers will provide a brief final statement.
4. Following the above and once the Committee feels it has gathered sufficient information, objectors, supporters and officers will be asked to leave the room whilst the Committee comes to a decision. N.B Officers from Law and Democracy will remain in the room, with the Committee, to provide legal advice and a written record of the decision.
5. All parties will be invited back into the room and the Chairman will advise the parties of the Committee's decision and the reasons for making it.
6. The decision, in writing, will be sent to relevant parties.

AGENDA ITEM:

**REPORT TO APPEALS &
COMPLAINTS COMMITTEE**

DATE: 8th AUGUST 2016

**REPORT OF THE DIRECTOR OF
ECONOMIC GROWTH &
DEVELOPMENT**

PROPOSED TRAFFIC REGULATION ORDER – GOOSE PASTURE, YARM

1.0 SUMMARY

The purpose of this report is to seek Members' views on 12 unresolved representations received, following statutory advertising of a proposal to amend the existing traffic Order on Goose Pasture in Yarm. The single yellow line restrictions are to be replaced with no waiting at anytime restrictions and to also include a new loading prohibition applicable Monday to Friday 8.30 to 9.30am and 2.30 to 4.30pm. These restrictions would also be extended to cover the bend at the fork in the road plus both sides of the southern fork leading to Rookery Woods, with the exception of the frontage of number 49 where the driveway is not fit for purpose.

The advertised traffic Order was progressed at the request of local residents following their ongoing concerns relating to legitimate parking on the existing single yellow lining and in locations where parking is not currently restricted on the incline and the bend, which result in road safety and traffic management issues.

Eleven of the representations received during statutory advertising represent number 49 Goose Pasture and are in regard to the proposed restrictions on both sides of the southern fork leading to Rookery Woods (only) not the proposals to amend the restrictions and to extend them to cover the bend. The twelfth objection is removed to the proposed restrictions for Goose Pasture and is associated with concerns relating to parking on another side road off The Spital – The Pines.

This report presents the response of the Director of Economic Growth and Development to the objections. It is not considered appropriate for the Director of Economic Growth and Development to consider the objections directly as he would effectively be reviewing his own decision.

2.0 RECOMMENDATIONS

It is recommended that:-

- (i) Members give consideration to the objections received during the statutory process, also to the comments in response from the Director of Economic Growth and Development, as detailed in this report.

3.0 BACKGROUND

- 3.1 Goose Pasture is a residential cul-de-sac, on an incline down from A67 The Spital, all properties have off street parking provision. Restrictions applicable Monday to Friday between 8am to 9am and 4pm to 5pm are already in place, indicated by a single yellow line and associated plates/signs. See plan from 2004 in **Appendix 1** from the existing traffic Order, the restrictions were originally implemented in 2001. The times of these restrictions

are no longer appropriate to address the parking issues, principally associated with Yarm School students and nursery traffic. As part of the consultation, some residents highlighted the traffic issues they experienced had been ongoing for 15 years.

- 3.2 Enforcement advise they are called to respond to issues at around 9:15am and 3:20pm which are outside of the operational times of the current restrictions. The contraventions thereby cannot be enforced effectively and the issues persist. 39 enforcement tasking requests were received by Enforcement Control Room for response in 2015.
- 3.3 Enforcement requested loading restrictions as part of the proposed amendment traffic Order to remove the requirement for Officer 'observation time' and reduce an Enforcement Officer's time away from the school gates where a presence is more desirable, in the early morning and afternoon.
- 3.4 The northern side of the fork has 22 detached properties situated on both sides, the southern fork has 6 detached properties on one (east) side only. There are footways, measuring approximately 1.8 metres wide, along both sides and the carriageway measures approximately 5 metres wide. Parking along the southern fork tends to be on one side only (the houses side). If parking occurred on the side opposite the houses it could potentially cause obstruction for residents and their visitors accessing and egressing their private, off street driveway.
- 3.5 Residents report parking causes an obstruction to the footway resulting in pedestrians using the road to pass, visibility at the bend and also at the junction with The Spital and to traffic movements generally but particularly on the incline and the bend. Parking issues are reported to be a result of Yarm School traffic, shoppers avoiding parking charges in Yarm and overnight parking by evening leisure visitors to the town as well as visitors during the annual Yarm Fair (October) and anglers accessing the river via Rookery Woods.
- 3.6 Traffic survey data for Goose Pasture before and after parking charges were introduced in Yarm town centre indicated a net increase of 3 vehicles overall and a maximum of 8 vehicles observed in total which is not a significant impact upon the availability of on street parking opportunity for residents, therefore residents have been informed that permit parking is not justified at Goose Pasture. Residents parking is also not implemented to address school parking issues which are not all day, everyday issues and schemes are not progressed for individual streets or single properties but for identifiable zones.
- 3.7 There have also been reports and concerns expressed relating to anti-social behaviour occurring in the woods causing nuisance and distress for some residents in the vicinity. This is not the reason for progressing the traffic Order although it would assist to some extent whereby Enforcement would have authority to move vehicles on from the restrictions if they are reported by residents to be acting suspiciously and would also prevent overnight parking for activities such as camping and alleged badger baiting.
- 3.8 Requests for traffic Orders cannot be dealt with immediately because of limited funding and resources available, they are therefore added to a list of similar requests and scored on a matrix against factors that rate its benefits to traffic management and road safety. Goose Pasture was added to that list awaiting prioritisation although it was not identified as an immediate priority and timescales for investigation could not be estimated. Therefore local residents approached their local Ward Councillors to seek their assistance in funding the traffic Order from their annual Ward budget. Ward Councillors agreed, subject to the proposals receiving an appropriate level of support from affected residents.
- 3.9 49 Goose Pasture has off street parking which the owner has highlighted is not functional because of it's steep incline and angle to the highway, therefore it is not fit for purpose and the residents rely on parking on street for their vehicles and those of their visitors. The area adjacent to the frontage of number 49 (approximately 28 metres) was left unrestricted

within the proposals for this reason, to enable on street parking to continue. If the area directly opposite this location was left unrestricted, parking on both sides could cause obstruction to traffic movements particularly for large vehicles.

- 3.10 In March 2016, the Director of Economic Growth and Development, in consultation with the Cabinet Member for Regeneration and Transport, authorised a recommendation to proceed through the statutory process for the outlined changes to the current waiting restrictions.
- 3.11 The Council may exercise discretion and issue waivers in exceptional circumstances, where it is deemed that a vehicle is required to park on as a temporary situation near to or adjacent to a specified property where waiting restrictions apply. This is typically for trade or utility service vehicles to assist in carrying out their duties. A waiver for parking on single or double yellow lines is only issued where the vehicle is absolutely necessary for the completion of the task at hand and is not a general dispensation to park illegally. There is a charge of £10 per day, up to a maximum charge of £100.

4.0 PROPOSED MEASURES (see Drawing TM2 / 208B in Appendix 2)

- 4.1 A permanent traffic regulation Order has been advertised for the existing waiting restrictions to be replaced with no waiting at anytime restrictions inclusive of a loading prohibition applicable Monday to Friday 8.30 to 9.30am and 2.30 to 4.30pm on Goose Pasture. The restrictions would also be extended to cover the bend at the fork and both sides of the southern fork leading to Rookery Woods, with the exception of the frontage of number 49 Goose Pasture. The restrictions would apply to residents and their visitors.

No waiting at anytime restrictions are represented on the ground as double yellow lines and the loading prohibition is represented as single kerb blips with associated plates/signs. Blue badge holders are exempt from the double yellow line restrictions for up to 3 hours as detailed in section 2 of "The Blue Badge scheme: rights and responsibilities in England". For general motorists there is a standard exemption on double yellow lines to allow boarding/alighting and loading/unloading activity on the double yellow lines. Loading restrictions do prevent parking by blue badge holders and loading/unloading activity.

5.0 CONSULTATION

- 5.1 A consultation letter drop took place with 27 households on Goose Pasture. 25 households responded (93%), all, including number 49, were in support of the proposal to change the single yellow line to double yellow and also that the lining is extended to protect the bend at the fork. Note number 55 Goose Pasture was not on the Gazeteer system used to formulate the mail merge and hence was not included in the consultation, however, the objectors from number 49 have subsequently pointed out that number 55 is owned by number 53, the objectors state there are 4 separate owners across the 5 properties in this area. The majority (3 out of 4 home owners, 75%) of respondents from the southern fork of Goose Pasture, supported the proposal to cover both sides of the road with restrictions to address potential displaced parking (arising from the proposed extended waiting restrictions and the loading restrictions) causing future issues and nuisance in that area. The traffic Order process is lengthy and costly (costs in this case are detailed in section 6) so to include restrictions to address potential future parking issues; for example parking on the southern fork opposite driveways, is a standard approach if, as in this case, it is practicable. It is understandable that residents would want to 'future proof' a scheme given they have stated they have been experiencing issues for 15 years.
- 5.2 The Officers' Traffic Group were consulted at their meeting on 3 December 2015 and updated at subsequent meetings since then. This is where consultation with the Police and the Council's Enforcement Service is undertaken at the feasibility stage, it is a long-standing forum for discussing relevant transport related issues within the Borough attended by

representatives from Cleveland Police in addition to Council Officers and public transport agents.

- 5.3 Local Ward Councillors and Yarm Town Council were consulted on the proposals. Responses received were included in the final approved report. It should be noted that Ward Councillors agreed to fund progression of the traffic Order.
- 5.4 In March 2016, the Director of Economic Growth and Development, in consultation with the Cabinet Member for Regeneration and Transport, agreed to the advertising of the proposals as outlined, via decision record EGDS.T.154.15

Statutory Consultation

- 5.5 The statutory consultation was conducted as required by the “Local Authorities Traffic Orders (Procedure) (England & Wales)) Regulations 1989” as amended. In practice, this involved publishing a public notice in the “Herald & Post”, 9 site notices were physically posted on the affected highway. Copies of the site notice, plan and draft traffic Order were available on the Council’s website for the duration. The statutory consultation period ended on 19 May 2016 and all Notices were removed from site on 9 June 2016.
- 5.6 During the statutory consultation, 12 representations were received, correspondence has been exchanged although the objectors, as detailed in this report, have indicated they wish to uphold their objections and the matter remains unresolved for Committee Members’ consideration. Copies of the correspondence exchanged are given as **Appendix 3**. The main points of the objections are summarised below with a response from the Director of Economic Growth and Development.

Objection Summary (also see Appendix 3)

- 5.7 **Dr. Jyoti Krishna, 49 Goose Pasture, Yarm, TS15 9EP.**

The restrictions from number 47 to 55 will prevent me and my visitors from parking in front of, or near, my house.

I have a short steep drive at an acute angle to the road, which cannot be used for parking especially in the winter and in icy conditions so my car and my visitors’ cars have to be parked on the road outside my house.

This traffic Order shows only the road in front of my property has been left clear which is not an acceptable alternative. My reasons are:

The only available free space remaining will be in front of my house so anyone driving into Goose Pasture looking for somewhere to park will end up parking in front of my house preventing me and my visitors from parking there. There is no other available space nearby as The Spital also has parking restrictions.

When residents of Goose Pasture have an excess of visitors or there are tradesmen working on their houses and their drives are full, the only place left for them to park will be in front of my house. At present, since there are no restrictions, my visitors are able to park further down the road from number 51 onwards.

Some of my neighbours already park in front of my house, leaving their drives vacant, just to prevent others from parking there. I have no assurance that this behaviour will stop once the restrictions are implemented.

I understand the restrictions are being demanded by some residents to deal with anti-social behaviour occurring in the woods. The woods can still be approached from The Spital without entering Goose Pasture so parking restrictions are not a solution to this.

Request resident only parking in front of my property or allow unrestricted parking on one side of the road from number 47 to 55.

I have lived in my house for the last 20 years with no restrictions in this part of Goose Pasture and it has not been a problem. If these parking restrictions are implemented future families that come to live here, are also likely to be impacted by not being able to park on the road outside their own homes. Property values may also suffer.

5.8 Response from the Director of Economic Growth and Development

There was a majority support from respondents to the residents consultation to cover both sides of the southern fork with restrictions. See consultation section for full details. As part of the consultation, the Council was advised that the issues had been ongoing concerns for residents for 15 years.

The proposal taken forward was to include comments received from the consultation including leaving the area adjacent to number 49 unrestricted.

Anti-social behaviour and environmental nuisance in, or near, the Woods has been reported to be causing distress and trouble for some residents in this vicinity. The restrictions would prohibit overnight parking and assist Enforcement in moving on vehicles, parked on the lining who residents report may be acting suspiciously and prevent overnight parking, but this is not the background purpose for their implementation.

The principal reason for progressing the proposals is to deal with existing road safety and traffic management issues on the incline and the bend/fork and to address issues potentially being displaced further along Goose Pasture. Residents in this area are concerned that parking will occur along the southern fork because there are only houses on one side so there is currently little on street parking demand by those residents and non residents may not see parking there as an issue if it is not directly adjacent to a private property. Goose Pasture is adopted highway and there are no rights to park, even outside of your own property, furthermore the Council cannot reserve a space on adopted public highway for a specific property. Residents parking is not practicable, as detailed in paragraph 3.6.

The area adjacent to number 49 would remain unrestricted and may therefore be available for parking. You and your visitors may choose to park across your driveway access which other residents and non residents would not be able to do as it would be obstructive and could be enforced as such. It is also permissible to park where restrictions are not laid elsewhere on Goose Pasture and also on a single yellow line if the time specific waiting restriction does not apply, such as on The Spital. The lining on The Spital applies Monday to Friday between 8am to 9am and 4pm to 5pm and therefore parking on a weekday between 9am and 4pm on those lines is acceptable.

If residents require parking for trades people working on their property, as they are likely to want parking close to the property they are working on, it is possible for them to apply to the Council for dispensation to waive the parking restrictions for that vehicle. There is usually a charge associated with a waiver and advanced notice to the Council would be required as detailed in paragraph 3.11 to this report. Furthermore, all other properties also have driveways that can accommodate some vehicles which is likely to be preferable when working on a specific property.

The restrictions, if implemented, would be present on site for potential house purchasers to see, or if they are currently in the process of viewing the proposals would be returned upon associated legal land searches.

5.9 The following objections are all associated with 49 Goose Pasture but were submitted as individual objections (as **Appendix 3**). The following summary highlights new matters not already covered in the previous objection and response.

5.10 **Nikhil Krishna**

The parking restrictions would deter innocent people who would otherwise be briefly parking their cars and going about their day.

5.11 **Response from the Director of Economic Growth and Development**

The proposals were developed at resident's requests and included all comments received from the consultation last year. The reason for progressing the proposals is to deal with existing road safety and traffic management issues and address potential issues being displaced further along Goose Pasture.

5.12 **Robina Jolly A.C.A, 51 Valley Drive, Yarm, TS15 9JQ**

I regularly visit my friend at No. 49 and we often have get togethers there and need space for more than a few cars – it is after all a residential street.

In addition, there is often a neighbours car parked outside No. 49, were this to continue, there may not be space for additional cars to park there. It is not clear where one would park if the existing single yellow line was to be made a double yellow line, together with restrictions on house nos. 47-55.

Please clarify the statement of reasons for this traffic order which states “the Council propose to make the above named Order for facilitating the passage on the road or any other road of any class of traffic (including pedestrians)”.

I have been a resident of Yarm for 30 years and again never known traffic restrictions of this kind on a residential street.

5.13 **Response from the Director of Economic Growth and Development**

Yellow lines will not be laid adjacent to number 49. If there are many visitors all arriving by car they could not all be accommodated wholly within the frontage of number 49, particularly given the driveway is unusable, some visitors must already be in the practice of parking elsewhere.

To clarify, the reasons for making the proposed traffic Order, these are limited to a choice listed in the “Road Traffic Regulation Act 1984” under which this proposed Order is drafted. The reason stated is a general ‘best fit’ in this situation, see policy content section to this report.

Single yellow line restrictions are usually sufficient to deal with parking with most parking problems in residential areas. However, residents in Goose Pasture wanted the existing single yellow line amending to a double to address parking on the single yellow, extending to cover the bend and also to address future issues arising and Enforcement requested the loading prohibition is included to assist them in efficient patrolling and action.

5.14 **Mohini Kelkar**

The proposed restrictions at Goose Pasture will pose serious parking problems for friends and family visiting the residents of Goose Pasture.

5.15 **Response from the Director of Economic Growth and Development**

Goose Pasture is adopted highway and there are no rights to park.

You may park where restrictions are not proposed to be laid on Goose Pasture and also on the single yellow line on The Spital providing it is at the times when the waiting restriction

does not apply. The current situation is causing problems for residents and resulted in the proposals being formulated.

5.16 Anand Krishna, 49 Goose Pasture, Yarm, TS15 9EP.

I grew up in number 49. I am currently studying at university, I return home during every holiday. Myself and my brother both drive, and our cars can be present in front of number 49. If double yellow lines were included in front of no 49, there would be regular occasions when individuals would have to park on them due to the absence of other parking. People such as cleaners and gardeners come and work in the house regularly.

5.17 Response from the Director of Economic Growth and Development

Yellow lines will not be laid adjacent to number 49, this is following discussions with your mother who has had regular contact with the Council and has explained the issue surrounding the driveway. The area adjacent to number 49 would be unrestricted and may therefore be available for you to park. If there are many visitors all arriving by car as you suggest they could not all be accommodated wholly within the frontage of number 49, particularly given the driveway is unusable, some visitors must already be in the practice of parking elsewhere. Your mother and her visitors may choose to park across the driveway access which other residents and non residents would not be able to do as it would be obstructive and could be enforced as such.

Parking on the double yellow lines would potentially incur a Penalty Charge Notice being issued to the offending vehicle. Blue badge holders are exempt from the double yellow line restrictions for up to 3 hours as detailed in section 2 of "The Blue Badge scheme: rights and responsibilities in England". For general motorists there is a standard exemption to allow boarding/alighting and loading/unloading activity on the double yellow lines outside of the times when the loading prohibition would be in operation.

5.18 Ananda Logishetty

I am a friend of a resident at number 49. I would like to raise an objection regarding not having any lines in front of her house.

5.19 Response from the Director of Economic Growth and Development

The majority of residents in the street have requested that the advertised restrictions are implemented and all properties of Goose Pasture do have provision of a private driveway. It is unclear if you object because the area adjacent to number 49 will not be covered by the proposed restrictions, this was following discussions with the resident since the driveway at that property is not fit for purpose.

5.20 Dr Manoj Krishna

I lived at 49 Goose Pasture from 1996 to 2008. Apparently the 'majority' of residents want the double yellow line imposing. Can you allow the majority to over-ride the genuine concerns of a minority?

5.21 Response from the Director of Economic Growth and Development

Consultation and the numbers involved are detailed in paragraph 5.1 - consultation. The frontage of number 49 was left unrestricted following the consultation whereby the comments received were incorporated where practicable.

5.22 Girish Vaze

It would be very inconvenient for visitors to park in the other places effectively inconveniencing other residents where these restrictions aren't planned. This is unfair to the visitors, the occupier of 49 Goose Pasture and to other residents.

5.23 Response from the Director of Economic Growth and Development

Goose Pasture is adopted highway and there are no rights to park. The majority of residents in the street have requested that the advertised restrictions are implemented after being informed through the consultation that the restrictions would apply to them and their visitors if implemented.

5.24 Punam Vaze, 29 St Martins Way Kirklevington, TS15 9NR.

As objection in paragraph 5.22.

5.25 Response from the Director of Economic Growth and Development

As response in paragraph 5.23.

5.26 Christine Beckwith

Friend lives at 49 Goose Pasture.

5.27 Response from the Director of Economic Growth and Development

Nothing further to add to other responses.

5.28 Donna Caldicott

I clean once a week at number 49 and I need to park my car outside her house to get my equipment out.

5.29 Response from the Director of Economic Growth and Development

No restrictions are proposed outside of number 49. However, if space was not available there you could park across the driveway of number 49 with the residents' permission. Furthermore, it is acceptable to load/unload equipment from your vehicle into the property by parking on the double yellow lines, therefore you could park on the lining, as long as it is outside the times when the loading restriction applies for this purpose.

Once loading activity has finished you would then need to park up elsewhere, this can be on any part of the highway where restrictions have not been laid as long as it would not cause an obstruction, there are some areas on Goose Pasture which will remain unrestricted and you may legally park on a weekday between 9am and 4pm on the single yellow line on The Spital.

5.30 The following objection is unrelated to the issues previously raised.

5.31 Mr M.C. Leach, 1 The Pines, Yarm, TS15 9EW.

More vehicles are taking note of the restrictions already in place on Goose Pasture and The Spital so are now parking further along The Spital. This results in road safety issues for vehicles leaving The Pines, particularly at school times. More vehicles are also parking in The Pines causing obstruction of driveways and there have been instances whereby vehicles turning in have had to reverse back out onto The Spital to allow a vehicle to exit.

Request residents parking signs at the entrance to The Pines to be considered in conjunction with markings at the junction of The Spital / The Pines to improve safety.

5.31 Response from the Director of Economic Growth and Development

Residents parking request

The Council also receives too many requests for residents permit parking to be dealt with immediately and requests are initially assessed against criteria in order to allocate funds to the areas which will benefit most from them. The criteria states residents parking schemes will not be prepared for individual streets, but for areas with clear boundaries in which parking by commuters is identified, through traffic surveys, as having a significant impact upon the availability of on street parking for local residents. Goose Pasture and The Pines do not meet the assessment criteria because the problems are associated with obstruction and inconsiderate parking rather than residents actually being unable to park relatively near to their property, since all properties on Goose Pasture and The Pines do have private, off street facilities.

Residents parking schemes are also not appropriate for areas adjacent to schools to deal with school time traffic issues given the very limited times when those issues occur, which tend to be during term time on week days. Existing schemes across the Borough operate for most of the day to address long stay commuter parking and make spaces available for permit holders to enable residents to park near their property.

Obstructive parking

It would be practicable to install a white 'H' marking across driveways, with residents' agreement. The marking advises motorists that it is a part of the carriageway which should be kept clear of parked vehicles and could be laid fairly promptly. This marking has been successful in discouraging inconsiderate and obstructive parking at other locations in the Borough. It is not backed by a traffic Order, however, parking on it can be enforced. Residents would all be consulted directly.

Double yellow lines around the junction with The Spital would be subject to a traffic Order, the request would need to be added to the list awaiting priority. Unfortunately, it is too late to add The Pines into the Goose Pasture Order because that Statutory consultation has already been carried out. However, a white 'H' marking could be laid fairly promptly to cover the junction plus 10 metres back into The Pines as an alternative to yellow lining.

6.0 FINANCIAL IMPLICATIONS

The cost of the first statutory notice was £329.40. A second notice would be required if the proposals progress to the traffic Order being made, the total for the statutory advertising element would be £658.80.

Amendments to the signing are estimated at £1,371.15, amendments to the lining would be required, detailed estimates have not been prepared but are anticipated to be in the region of £300 these costs would be met from the Yarm Ward Community Participation budget 2016/17.

7.0 POLICY CONTENT

The Council propose to make the Order for; facilitating the passage on the road or any other road of any class of traffic (including pedestrians). The reasons for making the proposed traffic Order are from a choice listed in the "Road Traffic Regulation Act 1984" under which this proposed Order is drafted. Therefore, since the principal reason for progressing the proposals is to deal with existing road safety and traffic management issues and to address potential issues being displaced further along Goose Pasture, this reason is a general 'best fit' in this situation.

8.0 CONCLUSION

The amendments advertised will enable appropriate enforcement and address residents' concerns arising from parking practices which currently occur legitimately on the existing waiting restrictions.

It is recommended that the proposals are progressed as advertised and that the objections are over ruled.

Corporate Director of Economic Growth and Development

Contact Officer : **Gillian Spence**
Tel No : **01642 526720**
E-mail address : **gillian.spence@stockton.gov.uk**

Environmental Implications

Addresses residents' concerns, as outlined.

Community Safety Implications

Addresses residents' concerns, as outlined.

Background Papers

Cabinet Member Report EGDS.T.154.15

Officers' Traffic Group meeting 3 December 2015, min 243/15 refers.

A67, High Street / The Spital, Yarm, Stockton-on-Tees (Prohibition of Waiting) Order 1999.

A67, High Street / The Spital, Yarm, Stockton-on-Tees (Prohibition of Waiting) Order 1999

Amendment (No.1) Order 2001.

The Borough of Stockton-on-Tees (A67, High Street / The Spital / Worsall Road, Yarm, Stockton-on-Tees) (Prohibition of Waiting) Order 2004.

Road Traffic Regulation Act 1984.

Education Related Item?

No.

Ward(s) and Ward Councillors:

Yarm Ward Councillors; E. Hampton, B. Houchen and J. Whitehill.

APPENDIX 1 - SINGLE YELLOW LINE RESTRICTIONS (2004).

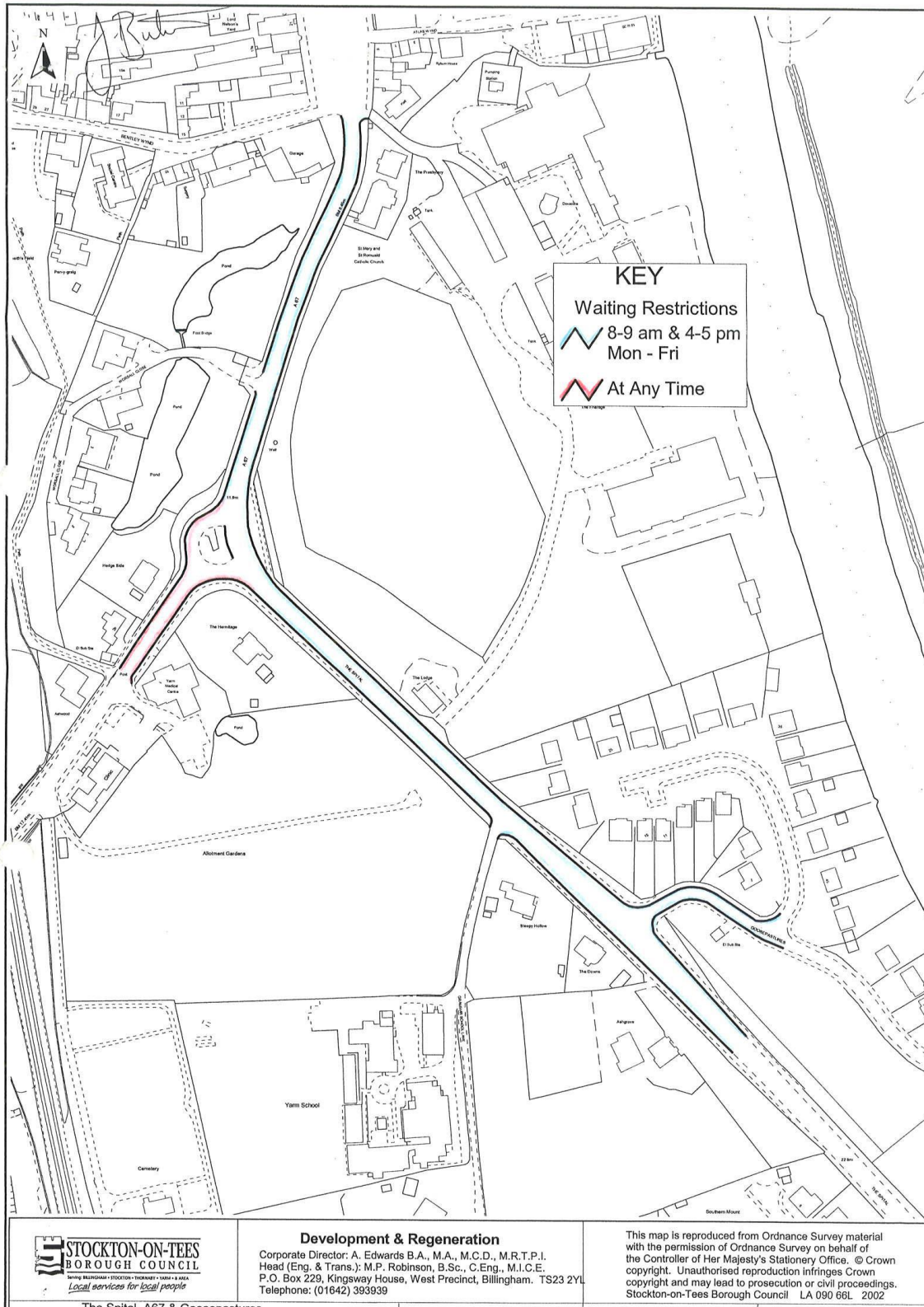

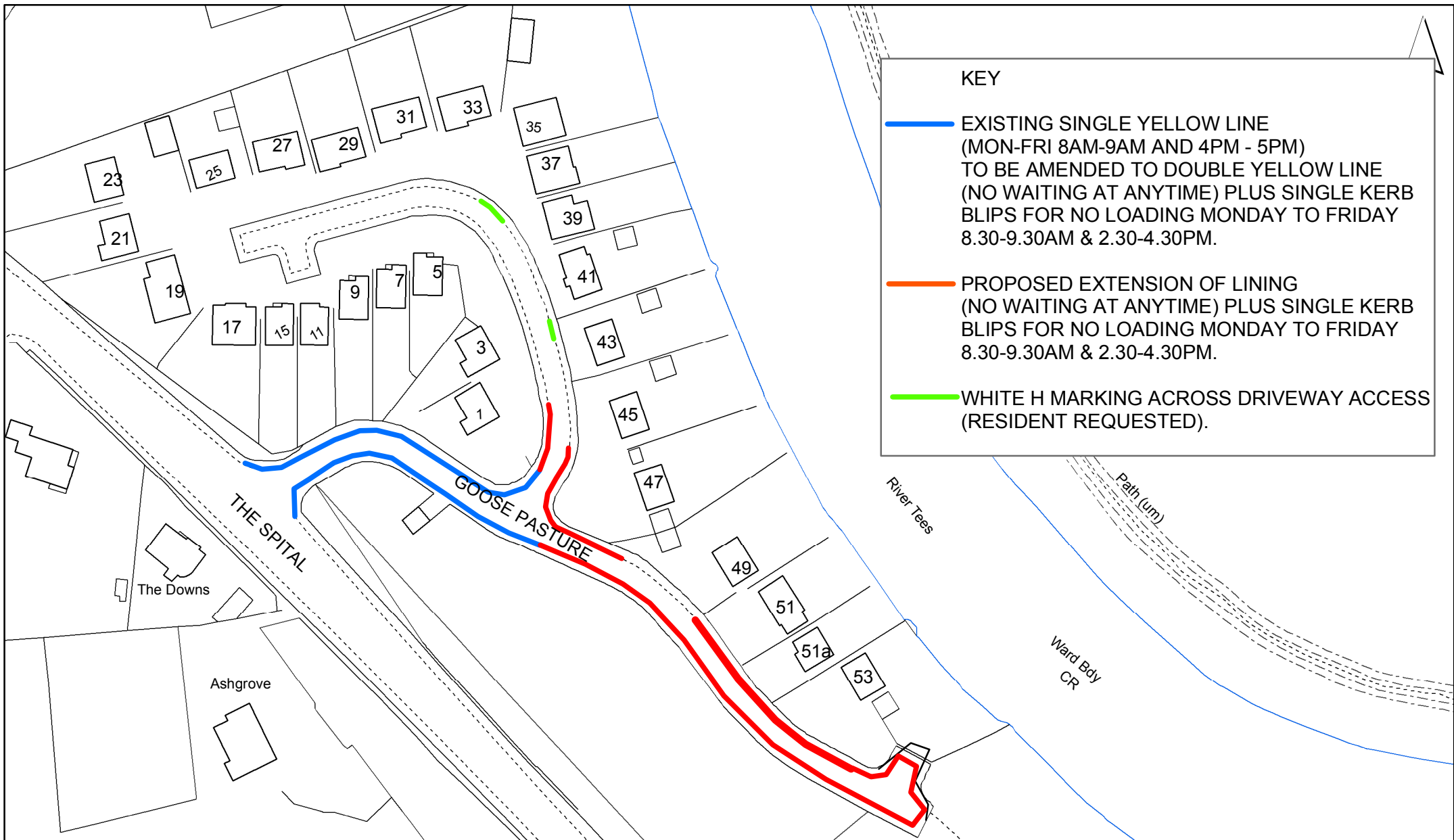

KEY

- EXISTING SINGLE YELLOW LINE (MON-FRI 8AM-9AM AND 4PM - 5PM) TO BE AMENDED TO DOUBLE YELLOW LINE (NO WAITING AT ANYTIME) PLUS SINGLE KERB BLIPS FOR NO LOADING MONDAY TO FRIDAY 8.30-9.30AM & 2.30-4.30PM.
- PROPOSED EXTENSION OF LINING (NO WAITING AT ANYTIME) PLUS SINGLE KERB BLIPS FOR NO LOADING MONDAY TO FRIDAY 8.30-9.30AM & 2.30-4.30PM.
- WHITE H MARKING ACROSS DRIVEWAY ACCESS (RESIDENT REQUESTED).

 <p>Stockton-on-Tees BOROUGH COUNCIL</p>	<p>Development & Neighbourhood Services</p> <p>Director of Economic Growth & Development: R McGuckin Kingsway House, West Precinct, Billingham. TS23 2NX Telephone: (01642) 393939</p>	<p>Title TM2/208B PROPOSED CHANGES TO RESTRICTIONS.</p> <p>GOOSE PASTURE, YARM</p>
<p>© Crown Copyright and database right 2015 Ordnance Survey 100023297</p>	<p>Page 23 of 90 Date OCTOBER 2015</p>	<p>Scale 1:1,250 at A4</p>

Dear Ms Spence

I have carefully read your response to my objection and have the following points to make:

1. You say '75% of residents specifically along the southern fork of Goosepasture' – One must be circumspect in the use of this statistic. There are only 5 houses on this part of the road – nos. 49, 51, 51a, 53, and 55. Numbers 53 and 55 are owned by the same person. Please be clear that the southern fork of Goosepasture has just 5 houses and 4 homeowners.

2. You say 'the principal reason for progressing the proposals is to deal with existing road safety and traffic management issues and to address potential issues being displaced further along Goose Pasture'.

The southern fork of Goosepasture has 5 houses. These are all on one side of the road. On the opposite side of the road is a wooded slope with no buildings. The southern fork is a dead end cul de sac with the Rookery woods beyond. The entire road is wide enough for the bin lorry to easily pass even when cars are parked on the roadside.

It is self-evident there are no road safety, traffic obstruction or hazardous parking issues in the southern fork.

It is the duty of the local authority to use the powers under the Road traffic Act regulations only where necessary to prevent traffic obstruction and hazardous parking. When the power is used where not necessary, it is an abuse of the power and contravenes the authority to regulate.

3. The use of public funds under the Act is discretionary and must be only where necessary and be justified by road safety and traffic management issues. Your proposal prevents users of a public highway from stopping even on the uninhabited side of a reasonably wide dead ended road when they cause no impediment by doing so.

The use of public funds in the southern fork of Goosepasture under your proposal is therefore not justified.

4. You have an obligation under the Equality Act to consider the impact on all highway users including disabled users who visit residents or the Rookery woods for more than 3 hours. Your proposal does not address this.

5. It is the duty of the authority when using the powers under the Act, to use discretion to ensure that the action proposed is proportionate and fair to all.

Your proposal has a disproportionate effect on my property and is unfair for the following reasons:

- a) No 49 is the only house with a steep acutely angled drive which is unusable especially in the cold weather - this makes having street parking essential for my family and visitors.

- b) No 49 is the first immediately visible property after the proposed parking restrictions. By leaving only the area in front of my property unrestricted in the whole southern fork of Goosepasture, it is blindingly obvious that anyone coming into Goosepasture looking to park will use this space.
- c) Tradespeople - There is a charge for a waiver and it requires advance notice. It is unrealistic that a window cleaner, plumber, electrician etc. visiting any of the houses on the southern fork for the day would have a paid waiver applied for. If the driveway for their property is occupied, they will park in the nearest area they can - which is the unrestricted area in front of no.49.

With your proposal, the potential displacement parking from the junction with the Spital that you say you are trying to address by restricting the rest of the southern fork will instead be displaced entirely into the area in front of no 49, where my family and I can park. This is unfair.

5. Service providers – Your proposal prevents council tax paying service providers such as care workers, domestic cleaners, gardeners etc. from carrying out their lawful business at properties in the southern fork, if they cannot stop on the public highway even when they are not causing an obstruction or parking hazard.

In conclusion –

Your proposal to restrict both sides of the southern fork of Goosepasture because some out of 5 current residents want it, is unjustified, poorly conceived and has a disproportionate and unfair impact on my property and my life and that of my family, friends and visitors.

It also unfairly impacts all users of the public highway and future residents of the properties in the southern fork of Goosepasture.

I will consider withdrawing my objection if you are willing to amend the proposal so that at least one side of the southern fork remains unrestricted. This will not cause any obstruction to traffic as already stated and will allow dispersment of any potential displaced parking along the entire length of a dead end road instead of affecting my property.

If you wish to progress the proposal as it stands, I uphold my objection and ask for this item to be referred to the Appeal and Complaints committee.

I feel very strongly about this and will pursue this further by all means necessary.

Please note that I will be out of the country between 21/7/16 and 4/8/16 and would be grateful if the committee hearing could be held outside of those dates to enable me to attend.

Yours sincerely

Dr J. Krishna

Spence, Gillian

From: Wilkinson, Sue
Sent: 14 June 2016 10:02
To: Spence, Gillian
Subject: FW: THE BOROUGH OF STOCKTON-ON-TEES GOOSE PASTURE, YARM TRAFFIC REGULATION ORDER 2016 J Krishna
Attachments: Response to GP traffic order.docx

This email was classified as : OFFICIAL

Hi Gillian

Please see below email.

Thanks

Sue

Please note that my working days are Tuesdays, Wednesdays and Fridays.

From: J Krishna
Sent: 12 June 2016 22:56
To: Wilkinson, Sue
Subject: Fwd: THE BOROUGH OF STOCKTON-ON-TEES GOOSE PASTURE, YARM TRAFFIC REGULATION ORDER 2016 J Krishna

Dear Ms Spence

Please find attached my response to your email below.

As stated in my response, I wish to uphold my objection to the proposal in its current form.

Regards
Jyoti Krishna

----- Forwarded message -----

From: Economic Growth and Development Services <EGDS@stockton.gov.uk>
Date: 6 June 2016 at 13:50
Subject: THE BOROUGH OF STOCKTON-ON-TEES GOOSE PASTURE, YARM TRAFFIC REGULATION ORDER 2016
To: " " >

This email was classified as : OFFICIAL

Dear Dr J. Krishna

THE BOROUGH OF STOCKTON-ON-TEES GOOSE PASTURE, YARM TRAFFIC REGULATION ORDER 2016

Further to your formal objection to the above advertised draft traffic Order, in particular the proposal to cover both sides of the southern fork of Goose Pasture with restrictions.

I am aware you were consulted on the proposals from the outset and have subsequently been in regular contact with the Council on this matter so you are aware of the background information on how and why the proposals were developed.

The majority (75%) of respondents to the residents consultation specifically along the southern fork of Goose Pasture strongly supported the proposal to cover both sides of the road with restrictions to address any displaced parking arising from the extended and amended times of the restrictions causing parking issues further into that area. As part of the consultation process, Enforcement Team requested consideration was given to including loading restrictions with the changes to the yellow lining. This removes the requirement for 'observation time' and reduces Enforcement Officer time away from school gates where a presence is more desirable in the early morning and afternoon.

The proposal taken forward was to include comments received from the consultation and change the single yellow line to double yellow, extend the restrictions to protect the bend, extend the restriction on both sides of the southern fork but to leave the area adjacent to your property and finally to include a Monday to Friday 8.30 – 9.30am and 2.30 – 4.30pm loading restriction. Some residents have reported anti-social behaviour and environmental nuisance in, or near the Woods, which was causing distress and trouble for some in this vicinity. The restrictions would assist Enforcement in moving on vehicles, parked on the lining who residents report may be acting suspiciously but this is not the background purpose for their implementation.

The principal reason for progressing the proposals is to deal with existing road safety and traffic management issues and to address potential issues being displaced further along Goose Pasture. As you are aware Goose Pasture is adopted highway and there are no rights to park, even outside of your own property, furthermore the Council cannot reserve a space on adopted public highway for a specific property.

The area adjacent to number 49 would be unrestricted and may therefore be available for you to park. You may also park where restrictions are not laid elsewhere on Goose Pasture and also on a single yellow line if the waiting restriction does not apply.

Should residents require parking for trades people working on their property, since they are likely to require parking close to the property they are working on, it is possible for them to apply to the

Council for a waiver for that vehicle for a limited period. There is usually a charge associated with a waiver and advanced notice to the Council would be required. Furthermore, as you state other properties also have driveways that can accommodate vehicles.

To clarify the reasons for making the proposed traffic Order, these reasons are limited to a choice of 6 as listed in the "Road Traffic Regulation Act 1984" under which this proposed Order is drafted. Therefore, since the principal reason for progressing the proposals is to deal with existing road safety and traffic management issues and to address potential issues being displaced further along Goose Pasture I trust you can see the reason "to facilitate the passage on the road" as being a general 'best fit' in this situation.

The restrictions, if implemented, would be present on site for potential house purchasers to see or if they are currently in the process of viewing the proposals would be returned upon land searches.

Given the above, the next stage is to ask you to please consider your objection, whether you wish to formally withdraw it, or uphold it. Should you wish your objection to stand, the item will be referred to the Council's Appeals and Complaints Committee. The Committee is independent to the Traffic Regulation Order process, as an objector you would be given every opportunity to address the Committee if you wish. I must make you aware that your correspondence will form part of the Appeals and Complaints Committee papers and it will therefore become a public document, at that stage. The alternative is to formally withdraw your objection.

A reply by e-mail is acceptable to Legal Services using the following address sue.wilkinson@stockton.gov.uk I would be grateful if could you please indicate your intentions in writing by 17 June 2016.

Thank you for your assistance.

Regards,

Gillian.

Gillian Spence

Engineer – Network Safety

Economic Growth and Development Services

Stockton-on-Tees Borough Council

Direct Line: 01642 526709

Email: egds@stockton.gov.uk

Stockton-on-Tees Borough Council

Kingsway House

Billingham

Stockton-on-Tees

TS23 2YL (TS23 2NX sat nav)

Main Switchboard: 01642 393939

www.stockton.gov.uk

Stockton-on-Tees
Host of the 2016 National
Road Race Championships
www.stockton.gov.uk/events

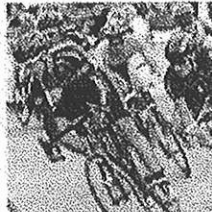
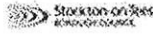

From: J Krishna [r]

Sent: 17 May 2016 21:47

To: Wilkinson, Sue

Subject: Objection to THE BOROUGH OF STOCKTON-ON-TEES GOOSE PASTURE, YARM TRAFFIC REGULATION ORDER 2016 Jyoti Krishna

Dear Mr Bond

I wish to object to part of the proposals contained in the proposed traffic order as clarified below.

I have no objection to converting the existing single yellow line to be made double yellow with kerb blips (no waiting and no loading) and also the extension to include the curve going down towards house numbers 47 and 1.

However I wish to object to applying the restrictions to the rest of the road from Nos 47 to 55 (No. 55 is after no. 53 and is not even shown on the proposal map!) as this will deprive me, my family and my friends from parking in front of or near my house.

I live at number 49. I opposed any restrictions on the road from nos 47-55 in the initial consultation (with Goosepasture residents) from the council. This is because I have a short steep drive at an acute angle to the road, which cannot be used for parking especially in the winter and in icy conditions. So my car and my family's and friends' cars have to be parked on the road outside my house.

This traffic order now shows only the road in front of most of my property has been left clear in the proposal (I do not understand why the lines have been proposed to include part of the frontage of number 49 and would like this also to be removed from the final plan). This is not an acceptable alternative to me.

My reasons for objecting are as follows:

1.If the rest of the road is converted to no parking at any time, the only available free space remaining will be that in front of my house (no 49).

Anyone driving into Goosepasture looking for somewhere to park will end up parking in front of my house preventing me, my family and friends from parking in front of my house. There is no other available space nearby as the Spital also has parking restrictions.

2. When residents of Goosepasture nos. 47-55 have an excess of visitors or there are tradesmen such as plumbers, gardeners etc working on these houses and their drives are full, the only place left for them to park will be in front of my house, again preventing me and my family and friends from parking in front of my house.

3.Some of my neighbours do not like non residents parking in Goosepasture. Everyday, these neighbours already park in front of my house, leaving their drives and parking spaces vacant, just to prevent others from parking there. At present, since there are no restrictions, my visitors therefore are able to park further down the road from no 51 onwards. I have no assurance that this behaviour will stop once the rest of the road has been made 'no parking at any time', since the space in front of my house will continue to be free of parking restrictions. And then my family/friends/visitors will be unable to park anywhere near my house.

4. In the statement of reasons on this traffic order states ::The Council propose to make the above named Order for facilitating the passage on the road or any other road of any class of traffic (including pedestrians). Can the council please explain how a small section of road with just 6 houses, ending in a cul-de-sac needs to be have double yellow lines on both sides of the road - what traffic is being impeded? The problem with traffic is where the existing single yellow and the junction with the Spital is, and **not** where the lines are being extended to include the stretch between nos 47-55.

I am also told that the parking restrictions in this part of Goosepasture are being demanded by some residents to deal with recent antisocial behaviour occurring in the woods at the end of Goosepasture. Has the opinion of the professionals, ie the police been sought by the council and have they said that 'no parking at any time' is the only way to deal with this problem? Have other options such as CCTV, extra policing been tried and found wanting? In any case the woods can still be approached on foot. on bicycles and indeed from the Spital itself without entering Goosepasture so parking restrictions are not a solution to antisocial behaviour in the woods.

Nobody including myself wants antisocial behaviour in their neighbourhood and I am completely supportive of efforts to deal with this. However I cannot accept a solution that deprives me of the right to a happy family and social life.

If this order is to be implemented, I would ask that the council either provide me with resident only parking spaces in front of my property OR allow unrestricted parking on at least one side of of the road from nos 47-55 Goosepasture so that I can still have a right to my family and social life.

5. I have lived in my house for the last 20 years with no restrictions on parking in this part of Goosepasture and it has not been a problem. In that time families have moved in and out of adjacent houses. If these parking restrictions are implemented as planned in the order, future families that come to live here, are also likely to be impacted by not being able to park on the road outside their own homes. Property values may also suffer as a consequence.

Please acknowledge receipt of my objection to this traffic order.

I have included my home and email address for the council only for communication. I do not wish any of my personal details to be made available to the public or on the council website.

Yours sincerely
Dr. Jyoti Krishna
49 Goosepasture
Yarm

Any opinions or statements expressed in this e mail are those of the individual and not necessarily those of Stockton-on-Tees Council/Tees Active Limited.

This e mail and any files transmitted with it are confidential and solely for the use of the intended recipient. If you receive this in error, please do not disclose any information to anyone and notify the sender at the above address.

Stockton-on-Tees Borough Council/Tees Active Limited`s computer systems and communications may be monitored to ensure effective operation of the system and for other lawful purposes.

Although we have endeavoured to ensure that this e mail and any attachments are free from any virus we would advise you to take any necessary steps to ensure that they are actually virus free.

S.10 NIKHIL KRISHNA

Spence, Gillian

From: Wilkinson, Sue
Sent: 21 June 2016 08:40
To: Spence, Gillian
Subject: FW: Traffic restrictions in goosepastures Nikhil Krishna

This email was classified as : OFFICIAL

Morning Gillian

Please see below email.

Sue

Please note that my working days are Tuesdays, Wednesdays and Fridays.

From: Nikhil Krishna
Sent: 15 June 2016 17:48
To: Wilkinson, Sue
Subject: Traffic restrictions in goosepastures

Dear Ms Spence,

Thank you for your reply. I will be upholding my objection to the proposal in its current form.

I would like to add to it the following points.

1. It has recently come to my attention that it is unlawful to use road traffic restrictions to deal with anti-social behaviour. When residents of the southern fork have explained to me their reasons for wanting restrictions in the southern fork, prevention of antisocial behaviour has been their main aim.

2. Secondly, I live here and I assure you that the magnitude of the traffic issues in the southern fork is nonexistent. When a car is parked on the roadside, a large lorry is easily able to pass along the road, suggesting that parked cars do not present an obstruction, rendering the invocation of the Road Traffic Act improper in this case. The lack of significant traffic management issues in the southern fork of G oosepasture therefore make the proposed restrictions a terrible waste of public funds. In a time of austerity, profligacy such as this directly impacts the taxpayers in the area and the important services the council provides to them.

3. Thirdly, the proposal does not take into account the impact on disabled people, as is legally required under the Equality Act.

Yours Sincerely,

Nikhil Krishna

Spence, Gillian

From: Spence, Gillian
Sent: 31 May 2016 12:45
To: Economic Growth and Development Services; Wilkinson, Sue
Subject: THE BOROUGH OF STOCKTON-ON-TEES GOOSE PASTURE, YARM TRAFFIC REGULATION ORDER 2016

This email was classified as : OFFICIAL.

EGDS - Please could you send this out for me to _____ 1 with a 'delivery' and a 'read' receipt on. Thanks

Sue – copy of reply to Goose Pasture TRO for your file, thanks.
Gillian

Dear Mr N. Krishna

THE BOROUGH OF STOCKTON-ON-TEES GOOSE PASTURE, YARM TRAFFIC REGULATION ORDER 2016

Further to your formal objection to the above advertised draft traffic Order.

I would firstly like to provide you with some background information on how the proposals were developed before responding to your specific concerns and asking how you wish to proceed in this matter.

Residents of Goose Pasture reported that they regularly experienced inconsiderate parking causing an obstruction and that parking on the bend near No 1 and No 45/47 and also on the existing single yellow line on the bank, was a road safety and traffic management concern when leaving/accessing the residential area. I note your support and agreement with these issues.

It was requested by residents that the Council give consideration to changing the single yellow line to double yellow and also to extending the yellow lines further to protect the bend from parking at all times. Since it would be feasible to amend the double yellow lining to cover the entire length, along both sides of Goose Pasture, that was also an option for residents to comment upon as part of a consultation that took place with all residents of Goose Pasture.

The consultation with residents had an excellent response rate at 93%. All respondents were in support of the proposal to change the single yellow line to double yellow and also that the lining is extended to protect the bend. Yellow lines will not be laid adjacent to number 49, this is following discussions with the resident who has had regular contact with the Council and has explained the issue surrounding the driveway. The majority (75%) of respondents specifically along the southern fork of Goose Pasture, that is the area leading to Rookery Woods, also strongly supported the proposal to cover both sides of the road with restrictions to address any displaced parking arising from the extended and amended times of the restrictions causing parking issues further into that area. As part of the consultation process, Enforcement Team requested consideration was given to including loading restrictions with the changes to the yellow lining. This removes the requirement for 'observation time' and reduces Enforcement Officer time away from school gates where a presence is more desirable in the early morning and afternoon.

Therefore, the proposal taken forward was actually to include all comments received from the consultation and change the single yellow line to double yellow, extend the restrictions to protect the bend, extend the restriction on both sides of the southern fork but to leave the area adjacent to number 49 at that residents' request and finally to include a Monday to Friday 8.30 – 9.30am and 2.30 – 4.30pm loading restriction to assist enforcement. Residents have also reported anti-social behaviour and environmental nuisance in, or near the Woods, which was causing distress and trouble for some in this vicinity. The restrictions would

assist Enforcement in moving on vehicles parked on the lining who residents report may be acting suspiciously but this is not the purpose of their implementation.

I trust this has explained the principal reason for progressing the proposals is to deal with existing road safety and traffic management issues and to address potential issues being displaced further along Goose Pasture. As part of the consultation I was advised that a petition was formulated by residents 15 years ago. Goose Pasture is adopted highway and there are no rights to park, even outside of your own property furthermore the Council cannot reserve a space on adopted public highway for a specific property.

The area adjacent to number 49 would be unrestricted and may therefore be available for you to park. You may also park where restrictions are not laid elsewhere on Goose Pasture and also on a single yellow line if the waiting restriction does not apply. The lining on The Spital for example applies Monday to Friday between 8am to 9am and 4pm to 5pm and you could therefore legally park on a weekday between 9am and 4pm on those lines. I consider that if there are many visitors all arriving by car to family gatherings they could not all be accommodated wholly within the frontage of number 49, particularly given the driveway is unusable, then some visitors must already be in the practice of parking elsewhere because once capacity across the frontage of 49 is reached it cannot be exceeded.

The majority of residents in the street have requested that the advertised restrictions are implemented and all properties of Goose Pasture do have provision of a private driveway.

Given the above, the next stage is to ask you to please consider your objection, whether you wish to formally withdraw it, or uphold it. Should you wish your objection to stand, the item will be referred to the Council's Appeals and Complaints Committee. The Committee is independent to the Traffic Regulation Order process, as an objector you would be given every opportunity to address the Committee if you wish. I must make you aware that your correspondence will form part of the Appeals and Complaints Committee papers and it will therefore become a public document at that stage. The alternative is to formally withdraw your objection.

A reply by e-mail is acceptable to Legal Services using the following address sue.wilkinson@stockton.gov.uk I would be grateful if could you please indicate your intentions by 15 June 2016.

Thank you for your assistance.

Regards,
Gillian.

Gillian Spence
Engineer – Network Safety
Economic Growth and Development

From: Nikhil Krishna
Sent: 19 May 2016 17:46
To: Wilkinson, Sue
Subject: Objection to proposed traffic regulation order, Goosepasture Nikhil Krishna

Dear Mr Bond,

I am writing to object to the proposed insertion of double yellow lines along the length of Goosepasture.

I will start by saying that I wholeheartedly agree with the proposal to put double yellow lines at the top of Goosepasture. It becomes unsafe when people park there or use the space to turn around, and the double yellow lines may prevent a future accident.

However, I must object to the extension of said lines down the road as outlined in the proposal. My reasons for doing so are outlined below.

Firstly, I am not convinced that the addition of the lines is the best way to deter anti-social behaviour in Goosepasture. I have heard tales of drug activity and other such acts of criminality, and it seems unlikely that those willing to break the law to such an extent will be deterred by the prospect of a parking fine. Furthermore, there would be nothing to stop these people from simply parking nearby and walking into Goosepasture to conduct their nefarious activities. Inevitably, the parking restrictions would simply deter innocent people who would otherwise be briefly parking their cars and going about their day, or even guests of residents.

Secondly, the proposed parking restrictions unfairly impact mine and my family's life at 49 Goosepasture. Leaving the space in front of our house free (which must be done, as the drive is small and inappropriately steep for winter parking) would mean that anyone who wishes to park their car there has every right to. It represents a get out of jail free card for all the residents who might otherwise have been inconvenienced by the parking restrictions, an insurance, in case they have workmen over or any such need for extra parking space that they do not have. They would inevitably end up using this space as an overflow car park, concentrating the problems against which they so ardently protested into the space directly in front of our house.

Thirdly, though this is in truth no concern of mine, current residents should keep in mind that these restrictions could lower the value of their homes in the event of a future resale. This links into my view that this entire debate has been overly short-term in outlook. The double yellow lines are a very permanent solution to what appears to be a recent problem. My family has lived on this street for 20 years, and the issues which these restrictions aim to prevent have not been an issue previously. In fact, parking is more of an issue now than before not due to strangers, but the actions of fellow residents who aim to deter these strangers.

Yours Sincerely,
Nikhil Krishna

PS: I do not wish for my personal details/those of my objection to be made available to the general public.

S.12 ROBINA JOLLY A.C.A

Spence, Gillian

From: Wilkinson, Sue
Sent: 15 June 2016 10:38
To: Spence, Gillian
Subject: FW: FW: THE BOROUGH OF STOCKTON-ON-TEES GOOSE PASTURE, YARM TRAFFIC REGULATION ORDER 2016

This email was classified as : OFFICIAL

Hi Gillian

Please see below email.

Sue

Please note that my working days are Tuesdays, Wednesdays and Fridays.

From: Robina Jolly
Sent: 15 June 2016 10:03
To: Wilkinson, Sue
Subject: FW: FW: THE BOROUGH OF STOCKTON-ON-TEES GOOSE PASTURE, YARM TRAFFIC REGULATION ORDER 2016

Dear Ms Spence,

I refer to you response of 31 May and would make the following comments:

1. I have regularly visited southern fork Goosepastures over the past 20 years, at varying times and days of the week and on no occasion have experienced or seen road safety and traffic management issues.
2. You state that "The majority (75%) of respondents specifically along the southern fork of Goose Pasture, that is the area leading to Rookery Woods, also strongly supported the proposal to cover both sides of the road with restrictions to address any displaced parking arising from the extended and amended times of the restrictions causing parking issues further into that area.

The Southern fork of Goosepastures has 5 houses on one side of the road. There are only 4 homeowners. The southern fork ends in a cul de sac and a dead end. I am yet to be explained how there can be a traffic obstruction in this small area.

I would also add that use of the statistic of "majority (75%) of respondents " across 4 homeowners is misleading and more caution needs to be exercised in use of this statistic as a supporting argument.

3. It is the duty of the local authority to use the powers under the Road traffic Act regulations only where necessary to prevent traffic obstruction and hazardous parking. When the power is used where not necessary, it is an abuse of the power and contravenes the authority to regulate.

How many times have the council or traffic police been called out to deal with road traffic incidents here? Are you able to provide supporting evidence?

4. One side of the southern fork of Goosepastures has no houses and the road is reasonably wide. I am again therefore of the view that there can be no justifiable traffic obstruction. I wish to state that the use of public funds under the Road Traffic Act is discretionary and must be only where necessary and be justified by road safety and traffic management issues. Your proposal prevents users of a public highway like myself from stopping even on the uninhabited side of a reasonably wide dead ended road when they cause no impediment by doing so.

The use of public funds in the southern fork of Goosepasture under your proposal is therefore not justified.

5. My elderly mother also visits my friend in No. 49 and your proposal makes no reference for disabled badge holders. How is this to be dealt with?

6. You state that if there are many visitors to No 49 "you may also park where restrictions are not laid elsewhere on Goose Pasture". It is unreasonable to displace parked cars from southern fork – an area with no traffic and houses only on one side of the road into elsewhere in Goose pastures with houses on both sides or onto the Spital which is a busy highway.

7. You state "Therefore, since the principal reason for progressing the proposals is to deal with existing road safety and traffic management issues and to address potential issues being displaced further along Goose Pasture I trust you can see the reason "to facilitate the passage on the road" as being a general 'best fit' in this situation."

Again, I re-iterate the point that having visited Goose pastures for the past 20 years and have never experienced any lack of "passage on the road".

8. If you wish to progress the proposal as it stands, I uphold my objection and ask for this item to be referred to the Appeal and Complaints committee.

Kind regards

Robina Jolly

From: Economic Growth and Development Services [<mailto:EGDS@stockton.gov.uk>]

Sent: 31 May 2016 12:48

To: Robina Jolly >

Subject: THE BOROUGH OF STOCKTON-ON-TEES GOOSE PASTURE, YARM TRAFFIC REGULATION ORDER 2016

This email was classified as : OFFICIAL

Dear Robina Jolly

THE BOROUGH OF STOCKTON-ON-TEES GOOSE PASTURE, YARM TRAFFIC REGULATION ORDER 2016

Further to your formal objection to the above advertised draft traffic Order.

I would firstly like to provide you with some background information on how the proposals were developed before responding to your specific concerns and asking how you wish to proceed in this matter.

Residents of Goose Pasture reported that they regularly experienced inconsiderate parking causing an obstruction and that parking on the bend near No 1 and No 45/47 and also on the existing single yellow line on the bank, was a road safety and traffic management concern when leaving/accessing the residential area.

It was requested by residents that the Council give consideration to changing the single yellow line to double yellow and also to extending the yellow lines further to protect the bend from parking at all times. Since it would be feasible to amend the double yellow lining to cover the entire length, along both sides of Goose Pasture, that was also an option for residents to comment upon as part of a consultation that took place with all residents of Goose Pasture.

The consultation with residents had an excellent response rate at 93%. All respondents were in support of the proposal to change the single yellow line to double yellow and also that the lining is extended to protect the bend.

The majority (75%) of respondents specifically along the southern fork of Goose Pasture, that is the area leading to Rookery Woods, also strongly supported the proposal to cover both sides of the road with restrictions to address any displaced parking arising from the extended and amended times of the restrictions causing parking issues further into that area. As part of the consultation process, Enforcement Team requested consideration was given to including loading restrictions with the changes to the yellow lining. This removes the requirement for 'observation time' and reduces Enforcement Officer time away from school gates where a presence is more desirable in the early morning and afternoon.

Therefore, the proposal taken forward was actually to include all comments received from the consultation and change the single yellow line to double yellow, extend the restrictions to protect the bend, extend the restriction on both sides of the southern fork but to leave the area adjacent to number 49 at that residents' request and finally to include a Monday to Friday 8.30 – 9.30am and 2.30 – 4.30pm loading restriction to assist enforcement. Residents have also reported anti-social behaviour and environmental nuisance in, or near the Woods, which was causing distress and trouble for some in this vicinity. The restrictions would assist Enforcement in moving on

vehicles parked on the lining who residents report may be acting suspiciously but this is not the purpose of their implementation.

In response to your point 1: Yellow lines will not be laid adjacent to number 49, this is following discussions with the resident who has had regular contact with the Council and has explained the issue surrounding the driveway. Since Goose Pasture is adopted highway there are no rights to park, even outside of your own property furthermore the Council cannot reserve a space on adopted public highway for a specific property. The area adjacent to number 49 would be unrestricted and may therefore be available for you to park. You may also park where restrictions are not laid elsewhere on Goose Pasture. I would suggest that if there are many visitors all arriving by car as you suggest they could not all be accommodated wholly within the frontage of number 49, particularly given the driveway is unusable, then some visitors must already be in the practice of parking elsewhere.

In regard to your point 2: Should residents require parking for trades people working on their property, since they are likely to require parking close to the property they are working on it is possible for them to apply to the Council for a waiver for that vehicle for a limited period. There is a charge associated with such a waiver and advanced notice would be needed.

The principal reason for progressing the proposals is to deal with existing road safety and traffic management issues and to address potential issues being displaced further along Goose Pasture. To clarify the reasons for making the proposed traffic Order, these are limited to a choice of 6 as listed in the "Road Traffic Regulation Act 1984" under which this proposed Order is drafted. Therefore, since the principal reason for progressing the proposals is to deal with existing road safety and traffic management issues and to address potential issues being displaced further along Goose Pasture I trust you can see the reason "to facilitate the passage on the road" as being a general 'best fit' in this situation.

Given the above, the next stage is to ask you to please consider your objection, whether you wish to formally withdraw it, or uphold it. Should you wish your objection to stand, the item will be referred to the Council's Appeals and Complaints Committee. The Committee is independent to the Traffic Regulation Order process, as an objector you would be given every opportunity to address the Committee if you wish. I must make you aware that your correspondence will form part of the Appeals and Complaints Committee papers and it will therefore become a public document at that stage. The alternative is to formally withdraw your objection.

A reply by e-mail is acceptable to Legal Services using the following address sue.wilkinson@stockton.gov.uk I would be grateful if could you please indicate your intentions by 15 June 2016.

Thank you for your assistance.

Regards,

Gillian.

Gillian Spence

Engineer – Network Safety

Economic Growth and Development Services
Stockton-On-Tees Borough Council
PO Box 229
Kingsway House

West Precinct
Billingham
TS23 2YL
Tel: 01642 526709
e-mail: EGDS@stockton.gov.uk
web: <http://www.stockton.gov.uk>



From: Robina Jolly | 1
Sent: 19 May 2016 07:32
To: Wilkinson, Sue
Subject: Objection to THE BOROUGH OF STOCKTON-ON-TEES GOOSE PASTURE, YARM TRAFFIC REGULATION ORDER 2016

Dear Mr Bond

I am writing to formally object to part of the proposals contained in the proposed traffic order as clarified below.

I am not objecting to the proposal to converting the existing single yellow line to be made double yellow and also the extension towards house numbers 47 and 1.

However I wish to object to applying the restrictions to the rest of the road from Nos 47 to 55 for the following reasons:

I regularly visit my friend at No. 49 Goosepastures and the proposed traffic restrictions from Nos 47 to 55 will not allow me and my friends or her family to park in front of No. 49. We often have friends and family get-togethers at No. 49 and hence need space for more than a few cars – it is after all a residential street.

In addition, there is often a neighbours car parked outside No. 49 – were this to continue, there may not be space for additional cars to park there. Indeed, it is not clear where one would park if the existing single yellow line was to be made a double yellow line, together with restrictions on house nos. 47-55.

I also wish to highlight the following:

1. Since your proposal is for the rest of Goosepastures to be no parking at any time except in front of 49 - the only available free space remaining will be that in front of house no 49. Anyone driving into Goosepastures looking for somewhere to park will end up parking in front of 49, thereby preventing any friends and family from parking in front of No. 49. Given that there is no other available space nearby (the Spital also has parking restrictions), where is it proposed that visitors of No 49 should park?

2. Equally, when residents of Goosepasture nos. 47-55 have an excess of visitors and their drives are full or there is building/house improvement work; then the tradesmen such as plumbers, gardeners etc working on these houses will have nowhere to park. The only place left for them to park will be in front of No. 49, thereby preventing visitors, family and friends visiting No 49 from parking in front of it.

I am also seeking a explanation on the following:

In the statement of reasons on this traffic order states :

The Council propose to make the above named Order for facilitating the passage on the road or any other road of any class of traffic (including pedestrians).

It is not clear why a residential street with only a few houses on it is subject to a new traffic order. I have been visiting at No. 49 Goosepastures for 20 years now and have never experienced any traffic issues.

I have been a resident of Yarm for 30 years and again never known traffic restrictions of this kind on a residential street.

Please acknowledge receipt of my objection to this traffic order.

I have included my home and email address to the council only for communication. I do not wish any of my personal details to be made available to the public or on the council website.

Yours sincerely

Robina Jolly

Robina Jolly A.C.A
51 Valley Drive,
Yarm, TS15 9JQ.

S.114 MOHINI KELKAR

Spence, Gillian

From: Wilkinson, Sue
Sent: 21 June 2016 08:59
To: Spence, Gillian
Subject: FW: Traffic regulation order, Goose Pasture, Yarm.

This email was classified as : OFFICIAL

Hi Gillian

Please see below email - I have acknowledged receipt.

Sue

Please note that my working days are Tuesdays, Wednesdays and Fridays.

-----Original Message-----

From: Dhananjay Kelkar
Sent: 16 June 2016 19:09
To: Wilkinson, Sue
Subject: Fwd: Traffic regulation order, Goose Pasture, Yarm.

Dear Ms Wilkinson,

While we are awaiting further communication from you in response to my earlier e-mail below, I wish to uphold my objection to the proposed Traffic regulation order at Goose Pasture.

Kindly acknowledge the receipt.

Regards,

Mohini Kelkar

>

> Begin forwarded message:

>

> From: Dhananjay Kelkar

>

> Date: 18 May 2016 at 11:53:24 GMT-5

> To:

> Sue.Wilkinson@stockton.gov.uk<<mailto:Sue.Wilkinson@stockton.gov.uk>>

> Cc: Jyoti Krishna

> Subject: Traffic regulation order, Goose Pasture, Yarm.

>

> Dear Ms Wilkinson,

>

> I wish to register my objection to the proposed traffic regulation at Goose Pasture as I believe it will pose serious parking problems for friends and family visiting the residents of Goose Pasture.

>

> Regards,

> Mohini Kelkar.

>

>

> Sent from my iPhone
>

Spence, Gillian

From: Spence, Gillian
Sent: 31 May 2016 12:40
To: Economic Growth and Development Services; Wilkinson, Sue
Subject: THE BOROUGH OF STOCKTON-ON-TEES GOOSE PASTURE, YARM TRAFFIC REGULATION ORDER 2016

This email was classified as : OFFICIAL

EGDS - Please could you send this out for me to _____ with a 'delivery' and a 'read' receipt on. Thanks

Sue – copy of reply to Goose Pasture TRO for your file, thanks.
Gillian.

Dear Mohini Kelkar

THE BOROUGH OF STOCKTON-ON-TEES GOOSE PASTURE, YARM TRAFFIC REGULATION ORDER 2016

Further to your formal objection to the above advertised draft traffic Order.

I would firstly like to provide you with some background information on how the proposals were developed before responding to your specific concern and asking how you wish to proceed in this matter.

Residents of Goose Pasture reported that they regularly experienced inconsiderate parking causing an obstruction and that parking on the bend near No 1 and No 45/47 and also on the existing single yellow line on the bank, was a road safety and traffic management concern when leaving/accessing the residential area.

It was requested by residents that the Council give consideration to changing the single yellow line to double yellow and also to extending the yellow lines further to protect the bend from parking at all times. Since it would be feasible to amend the double yellow lining to cover the entire length, along both sides of Goose Pasture, that was also an option for residents to comment upon as part of a consultation that took place with all residents of Goose Pasture.

The consultation with residents had an excellent response rate at 93%. All respondents were in support of the proposal to change the single yellow line to double yellow and also that the lining is extended to protect the bend.

The majority (75%) of respondents along the southern fork of Goose Pasture, that is the area leading to Rookery Woods, also strongly supported the proposal to cover both sides of the road with restrictions to address any displaced parking arising from the extended and amended times of the restrictions causing parking issues further into that area. As part of the consultation process, Enforcement Team requested consideration was given to including loading restrictions with the changes to the yellow lining. This removes the requirement for 'observation time' and reduces Enforcement Officer time away from school gates where a presence is more desirable in the early morning and afternoon.

Therefore, the proposal taken forward was to include all comments received from the consultation and change the single yellow line to double yellow, extend the restrictions to protect the bend, extend the restrictions on both sides of the southern fork but to leave the area adjacent to number 49 (at that residents' request) and finally to include a Monday to Friday 8.30 – 9.30am and 2.30 – 4.30pm loading restriction to assist enforcement. Some residents also reported anti-social behaviour and environmental nuisance in, or near the Woods, which was causing distress and trouble for some residents in this vicinity. The restrictions would assist Enforcement in moving on vehicles parked on the lining who residents report may be acting suspiciously.

Moving on to your specific grounds for objection. Goose Pasture is adopted highway and there are no rights to park, even outside of your own property furthermore the Council cannot reserve a space on adopted public highway for a specific property.

You may park where restrictions are not proposed to be laid on Goose Pasture and also on a single yellow line if the waiting restriction does not apply. The lining on The Spital for example applies Monday to Friday between 8am to 9am and 4pm to 5pm and you could therefore legally park on a weekday between 9am and 4pm on those lines. I do not know your personal circumstances but I should also make you aware that if you are a blue badge holder you may park on the double yellow lines for up to 3 hours, providing no obstruction is caused by doing so and therefore if this is applicable you may park on the lining when the loading restriction is not in operation.

The majority of residents in the street have requested that the advertised restrictions are implemented and all properties of Goose Pasture do have a private driveway.

Given the above, the next stage is to ask you to please consider your objection, whether you wish to formally withdraw it, or uphold it. Should you wish your objection to stand, the item will be referred to the Council's Appeals and Complaints Committee. The Committee is independent to the Traffic Regulation Order process, as an objector you would be given every opportunity to address the Committee if you wish. I must make you aware that your correspondence will form part of the Appeals and Complaints Committee papers and it will therefore become a public document at that stage. The alternative is to formally withdraw your objection.

A reply by e-mail is acceptable to Legal Services using the following address sue.wilkinson@stockton.gov.uk I would be grateful if could you please indicate your intentions by 15 June 2016.

Thank you for your assistance.

Regards,
Gillian.

Gillian Spence
Engineer – Network Safety
Economic Growth and Development

-----Original Message-----

From: Dhananjay Kelkar
Sent: 18 May 2016 17:53
To: Wilkinson, Sue
Cc: Jyoti Krishna
Subject: Traffic regulation order, Goose Pasture, Yarm.

Dear Ms Wilkinson,

I wish to register my objection to the proposed traffic regulation at Goose Pasture as I believe it will pose serious parking problems for friends and family visiting the residents of Goose Pasture.

Regards,
Mohini Kelkar.

Sent from my iPhone

5.16 ANAND KRISHNA

Spence, Gillian

From: Spence, Gillian
Sent: 13 June 2016 13:50
To: Economic Growth and Development Services; Wilkinson, Sue
Subject: THE BOROUGH OF STOCKTON-ON-TEES GOOSE PASTURE, YARM TRAFFIC REGULATION ORDER 2016
Attachments: TM2_208B.pdf

This email was classified as : OFFICIAL

EGDS - Please could you forward this so the attachment stays on to and also please close exor 57899, thanks

Sue copy of additional correspondence for your file.
Gillian

Dear Anand Krishna

THE BOROUGH OF STOCKTON-ON-TEES GOOSE PASTURE, YARM TRAFFIC REGULATION ORDER 2016

Further to your e-mail in connection with your formal objection to the above advertised draft traffic Order.

I note you do not wish to propose double yellow lines are implemented adjacent to number 49. I acknowledge you wish to uphold your objection and I shall inform Legal Services to this effect in order that an Appeals and Complaints Committee can be convened. You will be informed of the details for those arrangements in due course. I would anticipate a meeting to be held in late July/early August 2016.

For your information details of parking waivers can be found on the Council's website at the following link www.stockton.gov.uk/economic-regeneration-and-transport/car-parking/ as per previous correspondence a charge does apply, this is currently £10 per day.

I have attached a plan of the proposals for Goose Pasture, as included on the site Notices and on the Council's website, in order that you can see, for clarification, which areas of Goose Pasture will remain unrestricted under these proposals.

Regards,
Gillian

Gillian Spence
Engineer – Network Safety
Economic Growth and Development

Stockton-on-Tees
Host of the 2016 National
Road Race Championships
www.stockton.gov.uk/events



File: TS.T. 15.1 EXOR 57899.

From: Anand Krishna
Sent: 13 June 2016 10:17
To: Economic Growth and Development Services; Wilkinson, Sue
Subject: Re: THE BOROUGH OF STOCKTON-ON-TEES GOOSE PASTURE, YARM TRAFFIC REGULATION ORDER 2016

Dear Gillian,

Thank you for the reply. In response to your email I have the following concerns.

Regarding the waiver for workmen parking on double yellows, if there is a charge associated with this exemption then many will choose to avoid this by parking in front of number 49. Is there a way we can prevent this (apart from implementing double yellows in front of number 49)?

Secondly, you mention that there will be other areas of unrestricted parking in Goosepasture, does this refer to the Northern fork (the opposite direction to the woods)?

With regards to point 3, please allow me to clarify: I am not advocating double yellow lines to be placed in front of number 49.

I would like to formally uphold my objection, and agree to my correspondence becoming public documents.

Kind regards

Anand Krishna

On 31 May 2016, at 12:47, Economic Growth and Development Services <EGDS@stockton.gov.uk> wrote:

This email was classified as : OFFICIAL

Dear Anand Krishna

THE BOROUGH OF STOCKTON-ON-TEES GOOSE PASTURE, YARM TRAFFIC REGULATION ORDER 2016

Further to your formal objection to the above advertised draft traffic Order.

I would firstly like to provide you with some background information on how the proposals were developed before responding to your specific concerns and asking how you wish to proceed in this matter.

Residents of Goose Pasture reported that they regularly experienced inconsiderate parking causing an obstruction and that parking on the bend near No 1 and No 45/47 and also on the existing single yellow line on the bank, was a road safety and traffic management concern when leaving/accessing the residential area.

It was requested by residents that the Council give consideration to changing the single yellow line to double yellow and also to extending the yellow lines further to protect the bend from parking at all times. Since it would be feasible to amend the double yellow lining to cover the entire length, along both sides of Goose Pasture, that was also an option for residents to comment upon as part of a consultation that took place with all residents of Goose Pasture.

The consultation with residents had an excellent response rate at 93%. All respondents were in support of the proposal to change the single yellow line to double yellow and also that the lining is extended to protect the bend.

The majority (75%) of respondents specifically along the southern fork of Goose Pasture, that is the area leading to Rookery Woods, also strongly supported the proposal to cover

both sides of the road with restrictions to address any displaced parking arising from the extended and amended times of the restrictions causing parking issues further into that area. As part of the consultation process, Enforcement Team requested consideration was given to including loading restrictions with the changes to the yellow lining. This removes the requirement for 'observation time' and reduces Enforcement Officer time away from school gates where a presence is more desirable in the early morning and afternoon.

Therefore, the proposal taken forward was actually to include all comments received from the consultation and change the single yellow line to double yellow, extend the restrictions to protect the bend, extend the restriction on both sides of the southern fork but to leave the area adjacent to number 49 at that residents' request and finally to include a Monday to Friday 8.30 – 9.30am and 2.30 – 4.30pm loading restriction to assist enforcement. Residents have also reported anti-social behaviour and environmental nuisance in, or near the Woods, which was causing distress and trouble for some residents in this vicinity. The restrictions would assist Enforcement in moving on vehicles parked on the lining who residents report may be acting suspiciously but this is not the purpose of their implementation.

In response to your point 1: Yellow lines will not be laid adjacent to number 49, this is following discussions with your mother who has had regular contact with the Council and has explained the issue surrounding the driveway. Unfortunately, since Goose Pasture is adopted highway there are no rights to park, even outside of your own property furthermore the Council cannot reserve a space on adopted public highway for a specific property. In regard to your point 2: Should residents require parking for trades people working on their property, since they are likely to require parking close to the property they are working on it is possible for them to apply to the Council for a waiver for that vehicle for a limited period. There is usually a charge associated with such a waiver and advanced notice would be needed. Furthermore, as you state other properties also have driveways that can accommodate vehicles.

The area adjacent to number 49 would be unrestricted and may therefore be available for you to park. You may also park where restrictions are not laid elsewhere on Goose Pasture. I would suggest that if there are many visitors all arriving by car as you suggest they could not all be accommodated wholly within the frontage of number 49, particularly given the driveway is unusable, then some visitors must already be in the practice of parking elsewhere.

Yellow lines will not be laid adjacent to number 49. It is unclear from point 3 of your e-mail if you are requesting the restrictions to cover the frontage of number 49, this would be possible although would be subject to a second Statutory consultation and is contrary to the wishes recorded following consultation with your mother. Parking on the double yellow lines would potentially incur a Penalty Charge Notice being issued to the offending vehicle, except if the vehicle was displaying a valid blue badge, since that would remedy them exempt, for up to 3 hours, outside of the times when the loading prohibition would be in operation.

The principal reason for progressing the proposals is to deal with existing road safety and traffic management issues and to address potential issues being displaced further along Goose Pasture.

The restrictions, if implemented, would be present on site for potential house purchasers to see or if they are currently in the process of viewing, the proposals would be returned upon associated land searches.

Given the above, the next stage is to ask you to please consider your objection, whether you wish to formally withdraw it, or uphold it. Should you wish your objection to stand, the item will be referred to the Council's Appeals and Complaints Committee. The Committee is independent to the Traffic Regulation Order process, as an objector you would be given every opportunity to address the Committee if you wish. I must make you aware that your correspondence will form part of the Appeals and Complaints Committee papers and it will

therefore become a public document at that stage. The alternative is to formally withdraw your objection.

A reply by e-mail is acceptable to Legal Services using the following address sue.wilkinson@stockton.gov.uk I would be grateful if could you please indicate your intentions by 15 June 2016.

Thank you for your assistance.

Regards,
Gillian.

Gillian Spence
Engineer – Network Safety
Economic Growth and Development Services
Stockton-On-Tees Borough Council
PO Box 229
Kingsway House
West Precinct
Billingham
TS23 2YL
Tel: 01642 526709
e-mail: EGDS@stockton.gov.uk
web: <http://www.stockton.gov.uk>

<image001.jpg>

From: Anand Krishna
Sent: 17 May 2016 19:15
To: Wilkinson, Sue
Subject: Objection to proposed traffic regulation order - Goosepasture, 2016 - objection Anand Krishna

Dear Mr Bond,

I am writing to object to the planned implementation of double yellow lines to the road Goosepasture, specifically from numbers 47 to 55 with the exclusion of number 49.

I grew up in number 49, and my mother still lives there. Although I am currently studying at university, I return home during every holiday.

My objections are as follows:

1. If number 49 is to be excepted from the double yellow lines, any individual wishing to avoid hefty fines will choose to park outside number 49. This means that there is the possibility that myself, my mother or her visitors would not be able to park there, and could be fined for parking outside her house. Unlike other properties on Goosepasture, number 49 has a steep drive that does not sit perpendicular to the road, making it almost impossible to park on during icy weather. It is also only large enough for one car (without obstructing the pavement), unlike the drives of other Goosepasture residents.
2. Many residents of Goosepasture have, over the last few years, undertaken significant renovation of their properties (e.g. the new construction of number 55/51a and the renovation of number 47). If this were to continue, there would be no place to park for these workers and their vehicles, except in front of number 49, meaning my mother would be unable to park in front of the house.
3. One of the reasons we wish to be excepted from the double yellow lines, aside from the aforementioned steep angled drive, is the high number of visitors my family entertain at number 49. Aside from family and friends, people such as cleaners and gardeners do come and work in the house regularly. Additionally, myself and my brother both drive, and our car can also be present in front of number 49. If double yellow lines were included

in front of no 49, there would be regular occasions when individuals would have to park on them due to the absence of other parking.

4. It is my understanding that the proposed double yellow lines are an answer to recent anti-social behaviour taking place in the woods at the end of Goosepasture. Whilst I fully support any action to remove this from our neighbourhood, I do not believe a solution that prevents my family from entertaining their friends and visitors is an appropriate response.

5. Over the 20 years I have lived at Goosepasture (the last 2 years in holiday time), we have seen a number of neighbours move in and out of properties on the road. Any future family that may move into Goosepasture may find these restrictions on road parking much more of an issue.

6. An additional point is that by removing road parking, especially with the absence of any other viable parking for number 49, the value of the property may be adversely affected.

My details are listed for communication purposes, I do not wish this to be shared publicly if possible. Both my term time address at university and Goosepasture address are given.

Kind regards,
Anand Krishna

49 Goosepasture,
Yarm
TS15 9EP

Any opinions or statements expressed in this e mail are those of the individual and not necessarily those of Stockton-on-Tees Council/Tees Active Limited.

This e mail and any files transmitted with it are confidential and solely for the use of the intended recipient. If you receive this in error, please do not disclose any information to anyone and notify the sender at the above address.

Stockton-on-Tees Borough Council/Tees Active Limited's computer systems and communications may be monitored to ensure effective operation of the system and for other lawful purposes.

Although we have endeavoured to ensure that this e mail and any attachments are free from any virus we would advise you to take any necessary steps to ensure that they are actually virus free.

5.18 ANANDA LOGISHETTY

Spence, Gillian

From: Wilkinson, Sue
Sent: 31 May 2016 13:03
To: Spence, Gillian
Subject: RE: THE BOROUGH OF STOCKTON-ON-TEES GOOSE PASTURE, YARM TRAFFIC REGULATION ORDER 2016

This email was classified as : OFFICIAL

Thank you

Sue

Please note that my working days are Tuesdays, Wednesdays and Fridays.

From: Spence, Gillian
Sent: 31 May 2016 12:33
To: Economic Growth and Development Services; Wilkinson, Sue
Subject: THE BOROUGH OF STOCKTON-ON-TEES GOOSE PASTURE, YARM TRAFFIC REGULATION ORDER 2016

This email was classified as : OFFICIAL

EGDS - Please could you send this out for me to _____ with a 'delivery' and a 'read' receipt on. Thanks

Sue – copy of reply to Goose Pasture TRO for your file, thanks.
Gillian.

Dear Ananda Logishetty

THE BOROUGH OF STOCKTON-ON-TEES GOOSE PASTURE, YARM TRAFFIC REGULATION ORDER 2016

Further to your formal objection to the above advertised draft traffic Order.

I would firstly like to provide you with some background information on how the proposals were developed before responding to your specific concerns and asking how you wish to proceed in this matter.

Residents of Goose Pasture reported that they regularly experienced inconsiderate parking causing an obstruction and that parking on the bend near No 1 and No 45/47 and also on the existing single yellow line on the bank, was a road safety and traffic management concern when leaving/accessing the residential area.

It was requested by residents that the Council give consideration to changing the single yellow line to double yellow and also to extending the yellow line further to protect the bend from parking at all times. Since it would be feasible to amend the double yellow lining to cover the entire length, along both sides of Goose Pasture, that was also an option for residents to comment upon as part of a consultation that took place with all residents of Goose Pasture.

The consultation with residents had an excellent response rate at 93%. All respondents were in support of the proposal to change the single yellow line to double yellow and also that the lining is extended to protect the bend.

The majority (75%) of respondents along the southern fork of Goose Pasture, that is the area leading to Rookery Woods, also strongly supported the proposal to cover both sides of the road with the restrictions to address any displaced parking arising from the extended and amended times of the restrictions causing parking issues further into that area. As part of the consultation process, Enforcement Team requested consideration was given to including loading restrictions with the changes to the yellow lining. This removes the requirement for 'observation time' and reduces Enforcement Officer time away from school gates where a presence is more desirable in the early morning and afternoon.

Therefore, the proposal taken forward was to include all comments received from the consultation and change the single yellow line to double yellow, extend the restrictions to protect the bend, extend the restriction on both sides of the southern fork leading to the Woods but to leave the area adjacent to number 49 at that residents' request and finally to include a Monday to Friday 8.30 – 9.30am and 2.30 – 4.30pm loading restriction to assist enforcement. Residents also reported anti-social behaviour and environmental nuisance in, or near the Woods, which was causing distress and trouble for some residents in this vicinity. The restrictions would also assist Enforcement in moving on vehicles parked on the lining who residents report may be acting suspiciously.

Moving on to your specific grounds for objection, it is unclear if you object because the area adjacent to number 49 will not be covered by the proposed restrictions. I should advise that the reason for this is following discussions with the resident. To add in the restrictions to cover the frontage of number 49 would be possible although that would be subject to a second Statutory consultation and is contrary to the wishes recorded following consultation with the affected resident.

Goose Pasture is adopted highway and there are no rights to park, even outside of your own property furthermore the Council cannot reserve a space on adopted public highway for a specific property.

The area adjacent to number 49 would be unrestricted and may therefore be available for you to park. You may also park where restrictions are not laid elsewhere on Goose Pasture and also on a single yellow line if the waiting restriction does not apply. The lining on The Spital for example applies Monday to Friday between 8am to 9am and 4pm to 5pm and you could therefore legally park on a weekday between 9am and 4pm on those lines. I do not know your circumstances but I should also make you aware that if you are a blue badge holder you may park on the double yellow lines for up to 3 hours, providing no obstruction is caused by doing so and therefore if this is applicable you may park on the lining when the loading restriction is not in operation.

The majority of residents in the street have requested that the advertised restrictions are implemented and all properties of Goose Pasture do have provision of a private driveway.

Given the above, the next stage is to ask you to please consider your objection, whether you wish to formally withdraw it, or uphold it. Should you wish your objection to stand, the item will be referred to the Council's Appeals and Complaints Committee. The Committee is independent to the Traffic Regulation Order process, as an objector you would be given every opportunity to address the Committee if you wish. I must make you aware that your correspondence will form part of the Appeals and Complaints Committee papers and it will therefore become a public document at that stage. The alternative is to formally withdraw your objection.

A reply by e-mail is acceptable to Legal Services using the following address sue.wilkinson@stockton.gov.uk I would be grateful if could you please indicate your intentions by 15 June 2016.

Thank you for your assistance.

Regards,
Gillian.

Gillian Spence
Engineer – Network Safety
Economic Growth and Development

-----Original Message-----

From: Ananda Logishetty

Sent: 18 May 2016 06:18

To: Wilkinson, Sue

Subject: Objection - yellow lines goose pasture Amanda Logishetty

Dear Mr Bond

I wish to object to part of the proposals contained in the proposed traffic order.

I am a friend of a resident at number 49 in Goose pastures.

I would like to raise an objection regarding not having a any lines in front of her house.

It would highly inconvenience us from visiting her, as there will be no parking space available.

Would be great full if you could consider leaving the space in front of her house with Resident Parking only.

We hope you would consider hers and our proposal which is causing lot of anxiety for her and which I am concerned about.

Yours sincerely

Ananda Logishetty

Yarm

5.20 DR M. KRISHNA

Spence, Gillian

From: Wilkinson, Sue
Sent: 15 June 2016 09:17
To: Spence, Gillian
Subject: FW: Yarm Traffic Order - Manoj Krishna

This email was classified as : OFFICIAL

Hi Gillian

Please see below email.

Sue

Please note that my working days are Tuesdays, Wednesdays and Fridays.

From: Manoj Krishna
Sent: 15 June 2016 09:15
To: Wilkinson, Sue
Subject: Yarm Traffic Order

Dear Ms Wilkinson,

I wish to inform you that I wish to uphold my objection and look forward to addressing the Appeals Committee.

I would make the following points:

1. You cannot use percentages like 75% when there are only 5 properties.
2. I cannot see any 'road safety and traffic management issues' on that south fork of goosepasture. There is no hazardous parking or traffic obstruction there.
3. It is a waste of public funds to solve a problem that does not exist. I am a council tax payer to Stockton council and object to my contribution being used in this way.
4. No 49. is the only property with a very steep driveway where parking a vehicle is unsafe in cold and icy weather. So visitors and residents have to park on the street. If you only have no double yellow lines in front of the property, then everyone else of that street will park in front of No. 49.
5. If you wander down to Goosepasture you will see several vehicles belonging to neighbours and visitors and service providers already parked on the street. Where are they going to park?

One suggestion would be to have the double yellow lines in from of the houses, but leave the opposite side of the street without any lines at aall.

regards

Manoj Krishna

Spence, Gillian

From: Spence, Gillian
Sent: 31 May 2016 12:30
To: Economic Growth and Development Services; Wilkinson, Sue
Subject: THE BOROUGH OF STOCKTON-ON-TEES GOOSE PASTURE, YARM TRAFFIC REGULATION ORDER 2016

This email was classified as : OFFICIAL

EGDS - Please could you send this out for me to receipt on. Thanks with a 'delivery' and a 'read'

Sue – copy of reply to Goose Pasture TRO for your file, thanks.
Gillian.

Dear Dr M. Krishna

THE BOROUGH OF STOCKTON-ON-TEES GOOSE PASTURE, YARM TRAFFIC REGULATION ORDER 2016

Further to your formal objection to the above advertised draft traffic Order.

I would firstly like to provide you with some background information on how the proposals were developed before responding to your specific concerns and asking how you wish to proceed in this matter.

Residents of Goose Pasture reported that they regularly experienced inconsiderate parking causing an obstruction and that parking on the bend near No 1 and No 45/47 and also on the existing single yellow line on the bank, was a road safety and traffic management concern when leaving/accessing the residential area.

It was requested by residents that the Council give consideration to changing the single yellow line to double yellow and also to extending the yellow lines further to protect the bend from parking at all times. Since it would be feasible to amend the double yellow lining to cover the entire length, along both sides of Goose Pasture, that was also an option for residents to comment upon as part of a consultation that took place with all residents of Goose Pasture.

The consultation with residents had an excellent response rate at 93%. All respondents were in support of the proposal to change the single yellow line to double yellow and also that the lining is extended to protect the bend.

The majority (75%) of respondents specifically along the southern fork of Goose Pasture, that is the area leading to Rookery Woods, also strongly supported the proposal to cover both sides of the road with restrictions to address any displaced parking arising from the extended and amended times of the restrictions causing parking issues further into that area. As part of the consultation process, Enforcement Team requested consideration was given to including loading restrictions with the changes to the yellow lining. This removes the requirement for 'observation time' and reduces Enforcement Officer time away from school gates where a presence is more desirable in the early morning and afternoon.

Therefore, the proposal taken forward was to include all comments received from the consultation and change the single yellow line to double yellow, extend the restrictions to protect the bend, extend the restriction on both sides of the southern fork but to leave the area adjacent to number 49 at that residents' request and finally to include a Monday to Friday 8.30 – 9.30am and 2.30 – 4.30pm loading restriction to assist enforcement. Residents have also reported anti-social behaviour and environmental nuisance in, or near the Woods, which was causing distress and trouble for some residents in this vicinity. The restrictions

would assist Enforcement in moving on vehicles parked on the lining who residents report may be acting suspiciously but this is not the purpose of their implementation.

Single yellow line restrictions are usually sufficient to deal with parking with most parking problems in residential areas. However, 93% of residents in Goose Pasture wanted the existing single yellow line amending to a double to address parking on the single yellow. The principal reason for progressing the proposals is to deal with existing road safety and traffic management issues and to address potential issues being displaced further along Goose Pasture. Goose Pasture is adopted highway and there are no rights to park, even outside of your own property furthermore the Council cannot reserve a space on adopted public highway for a specific property.

The area adjacent to number 49 would be unrestricted and may therefore be available for you to park. You may also park where restrictions are not laid elsewhere on Goose Pasture and also on a single yellow line if the waiting restriction does not apply. The lining on The Spital for example applies Monday to Friday between 8am to 9am and 4pm to 5pm and you could therefore legally park on a weekday between 9am and 4pm on those lines. I do not know your circumstances but I should also make you aware that if you are a blue badge holder you may park on the double yellow lines for up to 3 hours, providing no obstruction is caused by doing so and therefore if this is applicable you may park on the lining when the loading restriction is not in operation.

Given the above, the next stage is to ask you to please consider your objection, whether you wish to formally withdraw it, or uphold it. Should you wish your objection to stand, the item will be referred to the Council's Appeals and Complaints Committee. The Committee is independent to the Traffic Regulation Order process, as an objector you would be given every opportunity to address the Committee if you wish. I must make you aware that your correspondence will form part of the Appeals and Complaints Committee papers and it will therefore become a public document at that stage. The alternative is to formally withdraw your objection.

A reply by e-mail is acceptable to Legal Services using the following address sue.wilkinson@stockton.gov.uk I would be grateful if could you please indicate your intentions by 15 June 2016.

Thank you for your assistance.

Regards,
Gillian.

Gillian Spence
Engineer – Network Safety
Economic Growth and Development

From: Manoj Krishna
Sent: 17 May 2016 18:20
To: Wilkinson, Sue
Subject: Parking changes in Goosepasture, Yarm.

Dear Ms Wilkinson,

I am writing to voice my objections to the parking changes proposed in Goosepasture for the following reasons:

1. I lived at 49 Goosepasture from 1996 till 2008. We never had any problems with parking , or the neighbours.
2. The double yellow lines will not change anti-social behaviour. They will just walk to the woods from the main road. If the police are concerned about this, perhaps a camera could be installed?

3. Very few estates, if any, have double yellow lines in the area. Can you tell me how many do? I cant think of any.

4. I visit my children often at 49 Goosepasture. Due to the nature of the slope I have to park on the main road. These restrictions would stop me visiting my children.

5. If you double yellow everything except the bit in front of 49 Goosepasture, then everyone else who is visiting someone will park there- as it is the only place to park.

6. Are you saying that residents of Goosepasture should not have any visitors? That is what would happen if you imposed this double yellow line rule.

7. Apparently the 'majority' of residents want the double yellow line imposing. Can you allow the majority to over-ride the genuine concerns of a minority? If you do want to do this, you need to come up with a solution that works for the residents of 49 Goosepasture. The council cannot just disregard the genuine concerns of people who live there. That is discrimination.

Please acknowledge this mail. I look forward to hearing from you.

Kind regards

Dr Manoj Krishna

S.22 GIRISH VAZE

Spence, Gillian

From: Wilkinson, Sue
Sent: 15 June 2016 13:19
To: Spence, Gillian
Subject: FW: objection to the proposed parking restrictions on Goose Pasture, Yarm Girish Vaze

This email was classified as : OFFICIAL

Hi Gillian

Please see below email.

Sue

Please note that my working days are Tuesdays, Wednesdays and Fridays.

From: girpunam([\[mailto: \]](#))
Sent: 15 June 2016 13:01
To: Wilkinson, Sue
Cc: jyoti ; kspine
Subject: Re: objection to the proposed parking restrictions on Goose Pasture, Yarm Girish Vaze

Hello and Good afternoon

I wish to uphold my objection to the proposed parking restrictions on Goose Pasture, Yarm.
I would be happy to participate in whichever way I can.

KInd regards

Girish Vaze

From: "Wilkinson, Sue" <Sue.Wilkinson@stockton.gov.uk>
Sent: Tue, 17 May 2016 16:15:58
To: "girpunam([\[mailto: \]](#))" <[\[mailto: \]](#)>
Subject: Re: objection to the proposed parking restrictions on Goose Pasture, Yarm

This email was classified as : OFFICIAL

Good Morning

Thank you for your email regarding the above, I will forward it to the Highways Section for their attention.

Kind regards

Sue Wilkinson

Please note that my working days are Tuesdays, Wednesdays and Fridays.

From: girpunam([\[mailto: \]](#))
Sent: 17 May 2016 11:31
To: Wilkinson, Sue
Subject: objection to the proposed parking restrictions on Goose Pasture, Yarm

Hello,

I have looked at the proposed restrictions on Goose Pasture, Yarm and I would like to object on the following grounds.

1. First and foremost - it is not clear how these restrictions would help the very purpose it is being implemented for. I do not know/am not aware of any increase in the criminality or illicit activity in this area. Also parking restrictions isn't a sensible way of curbing these activities. If the council or the residents are concerned about such activities - a consultation needs to happen with the Police. Measures such as Police Patrol or installing surveillance cameras would possibly better serve the purpose.
2. We frequently visit 49 Goose Pasture - and any a times there are many visitors at the same time - for family get together, celebrations etc. It would be very inconvenient for these visitors to park in the other places -effectively inconveniencing other residents where these restrictions aren't planned. This is unfair to the visitors, the occupier of 49 Goose Pasture and to other residents as stated above.
3. Although it may have attracted some sympathy from some local households (none of whom in my knowledge have put in any such request in the past 20 years or so), it is an ill-conceived, ill-thought of plan being taken forward at the request of possibly 1 or more residents.
4. It completely overlooks the right or convenience or otherwise of ALL the residents.
5. Leaving no line in from of 49 Goose Pasture, would then allow/encourage other vehicles to park there, further inconveniencing the occupier.

I would be more than happy to be a part of the consultation process and am willing to contribute in any constructive or meaningful way.

Girish Vaze

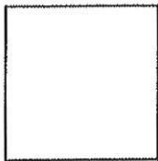

Get your own **FREE** website, **FREE** domain & **FREE** mobile app with Company email. [Know More >](#)

Any opinions or statements expressed in this e mail are those of the individual and not necessarily those of Stockton-on-Tees Council/Tees Active Limited.

This e mail and any files transmitted with it are confidential and solely for the use of the intended recipient. If you receive this in error, please do not disclose any information to anyone and notify the sender at the above address.

Stockton-on-Tees Borough Council/Tees Active Limited`s computer systems and communications may be monitored to ensure effective operation of the system and for other lawful purposes.

Although we have endeavoured to ensure that this e mail and any attachments are free from any virus we would advise you to take any necessary steps to ensure that they are actually virus free.

Spence, Gillian

From: Spence, Gillian
Sent: 31 May 2016 12:26
To: Economic Growth and Development Services; Wilkinson, Sue
Subject: THE BOROUGH OF STOCKTON-ON-TEES GOOSE PASTURE, YARM TRAFFIC REGULATION ORDER 2016

This email was classified as : OFFICIAL

EGDS - Please could you send this out for me to receipt on. Thanks with a 'delivery' and a 'read'

Sue – copy of reply to Goose Pasture TRO for your file, thanks. Gillian.

Dear Mr G. Vaze

THE BOROUGH OF STOCKTON-ON-TEES GOOSE PASTURE, YARM TRAFFIC REGULATION ORDER 2016

Further to your formal objection to the above advertised draft traffic Order.

I would firstly like to provide you with some background information on how the proposals were developed before responding to your specific concerns and asking how you wish to proceed in this matter.

Residents of Goose Pasture reported that they regularly experienced inconsiderate parking causing an obstruction and that parking on the bend near No 1 and No 45/47 and also on the existing single yellow line on the bank, was a road safety and traffic management concern when leaving/accessing the residential area.

It was requested by residents that the Council give consideration to changing the single yellow line to double yellow and also to extending the yellow lines further to protect the bend from parking at all times. Since it would be feasible to amend the double yellow lining to cover the entire length, along both sides of Goose Pasture, that was also an option for residents to comment upon as part of a consultation that took place with all residents of Goose Pasture.

The consultation with residents had an excellent response rate at 93%. All respondents were in support of the proposal to change the single yellow line to double yellow and also that the lining is extended to protect the bend.

The majority (75%) of respondents specifically along the southern fork of Goose Pasture, that is the area leading to Rookery Woods, also strongly supported the proposal to cover both sides of the road with restrictions to address any displaced parking arising from the extended and amended times of the restrictions causing parking issues further into that area. As part of the consultation process, Enforcement Team requested consideration was given to including loading restrictions with the changes to the yellow lining. This removes the requirement for 'observation time' and reduces Enforcement Officer time away from school gates where a presence is more desirable in the early morning and afternoon.

Therefore, the proposal taken forward was actually to include all comments received from the consultation and change the single yellow line to double yellow, extend the restrictions to protect the bend, extend the restriction on both sides of the southern fork but to leave the area adjacent to number 49 at that residents' request and finally to include a Monday to Friday 8.30 – 9.30am and 2.30 – 4.30pm loading restriction to assist enforcement. Residents have also reported anti-social behaviour and environmental nuisance in, or near the Woods, which was causing distress and trouble for some residents in this vicinity. The restrictions

would assist Enforcement in moving on vehicles parked on the lining who residents report may be acting suspiciously but this is not the purpose of their implementation.

I trust this has explained the principal reason for progressing the proposals is to deal with existing road safety and traffic management issues and to address potential issues being displaced further along Goose Pasture. As part of the consultation I was advised that a petition was formulated by residents 15 years ago. Goose Pasture is adopted highway and there are no rights to park, even outside of your own property furthermore the Council cannot reserve a space on adopted public highway for a specific property.

The area adjacent to number 49 would be unrestricted and may therefore be available for you to park. You may also park where restrictions are not laid elsewhere on Goose Pasture and also on a single yellow line if the waiting restriction does not apply. The lining on The Spital for example applies Monday to Friday between 8am to 9am and 4pm to 5pm and you could therefore legally park on a weekday between 9am and 4pm on those lines. You suggest that it is unreasonable to park in other places and that it would be inconvenient to other residents, I would suggest that if there are many visitors all arriving by car to family gatherings they could not all be accommodated wholly within the frontage of number 49, particularly given the driveway is unusable, then some visitors must already be in the practice of parking elsewhere.

The majority of residents in the street have requested that the advertised restrictions are implemented and all properties of Goose Pasture do have provision of a private driveway.

Yellow lines will not be laid adjacent to number 49. It is unclear from point 5 of your e-mail if you are requesting the restrictions to cover the frontage of number 49, this would be possible although would be subject to a second Statutory consultation and is contrary to the wishes recorded following consultation with the affected resident.

Given the above, the next stage is to ask you to please consider your objection, whether you wish to formally withdraw it, or uphold it. Should you wish your objection to stand, the item will be referred to the Council's Appeals and Complaints Committee. The Committee is independent to the Traffic Regulation Order process, as an objector you would be given every opportunity to address the Committee if you wish. I must make you aware that your correspondence will form part of the Appeals and Complaints Committee papers and it will therefore become a public document at that stage. The alternative is to formally withdraw your objection.

A reply by e-mail is acceptable to Legal Services using the following address sue.wilkinson@stockton.gov.uk I would be grateful if could you please indicate your intentions by 15 June 2016.

Thank you for your assistance.

Regards,
Gillian.

Gillian Spence
Engineer – Network Safety
Economic Growth and Development

From: girpunam
Sent: 17 May 2016 11:31
To: Wilkinson, Sue
Subject: objection to the proposed parking restrictions on Goose Pasture, Yarm

Hello,

I have looked at the proposed restrictions on Goose Pasture, Yarm and I would like to object on the following grounds.

1. First and foremost - it is not clear how these restrictions would help the very purpose it is being implemented for. I do not know/am not aware of any increase in the criminality or illicit activity in this area. Also parking restrictions isn't a sensible way of curbing these activities. If the council or the residents are concerned about such activities - a consultation needs to happen with the Police. Measures such as Police Patrol or installing surveillance cameras would possibly better serve the purpose.

2. We frequently visit 49 Goose Pasture - and any a times there are many visitors at the same time - for family get together, celebrations etc. It would be very inconvenient for these visitors to park in the other places -effectively inconveniencing other residents where these restrictions aren't planned. This is unfair to the visitors, the occupier of 49 Goose Pasture and to other residents as stated above.
3. Although it may have attracted some sympathy from some local households (none of whom in my knowledge have put in any such request in the past 20 years or so), it is an ill-conceived, ill-thought of plan being taken forward at the request of possibly 1 or more residents.
4. It completely overlooks the right or convenience or otherwise of ALL the residents.
5. Leaving no line in from of 49 Goose Pasture, would then allow/encourage other vehicles to park there, further inconveniencing the occupier.

I would be more than happy to be a part of the consultation process and am willing to contribute in any constructive or meaningful way.

Girish Vaze

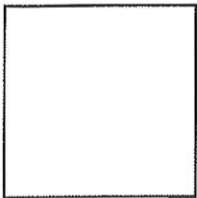

Get your own **FREE** website, **FREE** domain & **FREE** mobile app with Company email. [Know More >](#)

S.24 PUNAM VAZE

Spence, Gillian

From: Wilkinson, Sue
Sent: 21 June 2016 08:45
To: Spence, Gillian
Subject: FW: THE BOROUGH OF STOCKTON-ON-TEES GOOSE PASTURE, YARM TRAFFIC REGULATION ORDER 2016

This email was classified as : OFFICIAL

Hi Gillian

Please see below email.

Sue

Please note that my working days are Tuesdays, Wednesdays and Fridays.

From: punam vaze
Sent: 15 June 2016 21:55
To: Wilkinson, Sue
Subject: THE BOROUGH OF STOCKTON-ON-TEES GOOSE PASTURE, YARM TRAFFIC REGULATION ORDER 2016

Dear Mrs Spence and Ms Wilkinson

Thank you for your response to my objection .

I feel it does not address my concerns.

In all the 20 years that we have visited my relative in 49 goose pastures, we have never had a problem because of inappropriate parking. There has never been an obstruction to traffic on that road.

All the homes on the Southern fork of Goosepastures are on one side of the road only.

It would be agreeable and understandable to put double yellow lines on one side of the road only .

The unsavory activity in the woods at the end of the culdesac is a policing matter, and cannot and should not be addressed by inconveniencing the public with parking restriction.

My mother, who is disabled, often visits number 49 Goosepastures, and she often stays beyond the 3 hours allowed for a disable badge user to park on double yellow lines.

What protection or reassurance can be offered to ensure that visitors or work people visiting homes other than number 49 do not park in front of number 49 , this being the only area without double yellow lines?

I am deeply concerned that the council is using public funds to carry out a proposal which has very little benefit and is unfair to the residents and visitors to number 49.

The Southern fork of Goosepastures is quite some way down from the main road, and opportunistic parking for school and Yarm is mainly on the upper part of the Road.

Your original email had asked for a response by the 3rd of June, however, your email was sent on the 31st of May.

Mrs Krishna has advised me Mrs Spence has agreed for the date of the response to be the 15th of June 16.

Kind Regards,

Mrs Punam Vaze

Spence, Gillian

From: Spence, Gillian
Sent: 31 May 2016 12:22
To: Economic Growth and Development Services; Wilkinson, Sue
Subject: THE BOROUGH OF STOCKTON-ON-TEES GOOSE PASTURE, YARM TRAFFIC REGULATION ORDER 2016

This email was classified as : OFFICIAL

EGDS - Please could you send this out for me to
'read' receipt on. Thanks

with a 'delivery' and a

Sue – copy of reply to Goose Pasture TRO for your file, thanks.
Gillian.

Dear Mrs P. Vaze

THE BOROUGH OF STOCKTON-ON-TEES GOOSE PASTURE, YARM TRAFFIC REGULATION ORDER 2016

I would firstly like to provide you with some background information on how the proposals were developed before responding to your specific concerns and asking how you wish to proceed in this matter.

Residents of Goose Pasture reported that they regularly experienced inconsiderate parking causing an obstruction and that parking on the bend near No 1 and No 45/47 and also on the existing single yellow line on the bank, was a road safety and traffic management concern when leaving/accessing the residential area.

It was requested by residents that the Council give consideration to changing the single yellow line to double yellow and also to extending the yellow lines further to protect the bend from parking at all times. Since it would be feasible to amend the double yellow lining to cover the entire length, along both sides of Goose Pasture, that was also an option for residents to comment upon as part of a consultation that took place with all residents of Goose Pasture.

The consultation with residents had an excellent response rate at 93%. All respondents were in support of the proposal to change the single yellow line to double yellow and also that the lining is extended to protect the bend.

The majority (75%) of respondents specifically along the southern fork of Goose Pasture, that is the area leading to Rookery Woods, also strongly supported the proposal to cover both sides of the road with restrictions to address any displaced parking arising from the extended and amended times of the restrictions causing parking issues further into that area. As part of the consultation process, Enforcement Team requested consideration was given to including loading restrictions with the changes to the yellow lining. This removes the requirement for 'observation time' and reduces Enforcement Officer time away from school gates where a presence is more desirable in the early morning and afternoon.

Therefore, the proposal taken forward was actually to include all comments received from the consultation and change the single yellow line to double yellow, extend the restrictions to protect the bend, extend the restriction on both sides of the southern fork but to leave the area adjacent to number 49 at that residents' request and finally to include a Monday to Friday 8.30 – 9.30am and 2.30 – 4.30pm loading restriction to assist enforcement. Residents have also reported anti-social behaviour and environmental nuisance in, or near the Woods, which was causing distress and trouble for some residents in this vicinity. The restrictions would assist Enforcement in moving on vehicles parked on the lining who residents report may be acting suspiciously but this is not the purpose of their implementation.

I trust this has explained the principal reason for progressing the proposals is to deal with existing road safety and traffic management issues and to address potential issues being displaced further along Goose Pasture. Goose Pasture is adopted highway and there are no rights to park, even outside of your own property, furthermore the Council cannot reserve a space on adopted public highway for a specific property.

The area adjacent to number 49 would be unrestricted and may therefore be available for you to park. You may also park where restrictions are not laid elsewhere on Goose Pasture and also on a single yellow line if the waiting restriction does not apply. The lining on The Spital for example applies Monday to Friday between 8am to 9am and 4pm to 5pm and you could therefore legally park on a weekday between 9am and 4pm on those lines. You suggest that it is unreasonable to park in other places and that it would be inconvenient to other residents, I would suggest that if there are many visitors all arriving by car to family gatherings they could not all be accommodated wholly within the frontage of number 49, particularly given the driveway is unusable, then some visitors must already be in the practice of parking elsewhere.

The majority of residents in the street have requested that the advertised restrictions are implemented and all properties of Goose Pasture do have provision of a private driveway.

Yellow lines will not be laid adjacent to number 49. It is unclear from point 5 of your e-mail if you are requesting the restrictions to cover the frontage of number 49, this would be possible although would be subject to a second Statutory consultation and is contrary to the wishes recorded following consultation with the affected resident.

Given the above, the next stage is to ask you to please consider your objection, whether you wish to formally withdraw it, or uphold it. Should you wish your objection to stand, the item will be referred to the Council's Appeals and Complaints Committee. The Committee is independent to the Traffic Regulation Order process, as an objector you would be given every opportunity to address the Committee if you wish. I must make you aware that your correspondence will form part of the Appeals and Complaints Committee papers and it will therefore become a public document at that stage. The alternative is to formally withdraw your objection.

A reply by e-mail is acceptable to Legal Services using the following address sue.wilkinson@stockton.gov.uk I would be grateful if could you please indicate your intentions by 3 June 2016.

Thank you for your assistance.

Regards,
Gillian.

Gillian Spence
Engineer – Network Safety
Economic Growth and Development

From: punam vaze
Sent: 17 May 2016 22:13
To: Wilkinson, Sue
Subject: Objection to Proposal of Double Yellow Lines at Goose pastures Punam Vaze

Hello,

Please see the attachment regarding my objection to the above proposal

With regards,

Punam Vaze

17.05.16

Dear Madam,

With regards to the proposed restrictions on Goose Pasture, Yarm I would like to object on the following grounds.

1. It is not clear how these restrictions would help the very purpose it is being implemented for. I have visited 49 Goose Pastures as a relative of the owner for around 20 years. I have not noted any increase or change in antisocial behaviour in this area over this time.
2. Parking restrictions do not appear to be a reasonable way of curbing these activities. Measures such as Police Patrol or installing surveillance cameras would possibly better serve the purpose.
3. We frequently visit 49 Goose Pasture - and any a times there are many visitors at the same time - for family get together, celebrations etc. It would be very inconvenient for these visitors to park in the other places -effectively inconveniencing other residents where these restrictions aren't planned. This is unfair to the visitors, the occupier of 49 Goose Pasture and to other residents as stated above.
4. It completely overlooks the right or convenience of ALL the residents.
5. Leaving no yellow line in front of 49 Goose Pasture, would then allow/encourage other vehicles to park there, further inconveniencing the occupier.

With kind regards,
Mrs Punam Vaze
29, St Martins Way Kirklevington
TS15 9NR

526 CHRISTINE BECKWITH

Spence, Gillian

From: Wilkinson, Sue
Sent: 14 June 2016 09:50
To: Spence, Gillian
Subject: FW: Double yellow lines

This email was classified as : OFFICIAL

Hi Gillian

Not sure if you received this one. Please see below email.

Thanks

Sue

Please note that my working days are Tuesdays, Wednesdays and Fridays.

-----Original Message-----

From: [swan](#)
Sent: 13 June 2016 17:44
To: Wilkinson, Sue
Subject: Re: Double yellow lines

Hello regarding 49 goose pastures yarm it is a very quite road only people who live there or friends park down there ,so they is no dangerous parking or hazards at all, so hope they won't be any need for double yellow lines kind regards Christine Beckwith

Sent from my iPhone

> On May 18, 2016, at 7:17 AM, "Wilkinson, Sue" <Sue.Wilkinson@stockton.gov.uk> wrote:

>

> This email was classified as : OFFICIAL

>

> Good Morning

>

> Thank you for your below email, I have forwarded the same to the Highways Section for their attention and you should hear from them in due course.

>

> Kind regards

>

> Sue Wilkinson

>

> Please note that my working days are Tuesdays, Wednesdays and Fridays.

>

> -----Original Message-----

> **From:** [swan](#)
> **Sent:** 17 May 2016 20:02
> **To:** Wilkinson, Sue
> **Subject:** Double yellow lines

>

> Hi my friend lives in 49 goose pastures and as done for 20 years , her drive is not suitable to park on so when visiting her they will be no where to park if yellow lines go down she as never had a problem before and if they leave lines off outside her house other people will park there.

> Kind regards Christine Beckwith

> Sent from my iPhone

>

>

> *****

> ***** Any opinions or statements expressed in

> this e mail are those of the individual and not necessarily those of

> Stockton-on-Tees Council/Tees Active Limited.

>

> This e mail and any files transmitted with it are confidential and

> solely for the use of the intended recipient. If you receive this in

> error, please do not disclose any information to anyone and notify the sender at the above address.

>

> Stockton-on-Tees Borough Council/Tees Active Limited`s computer

> systems and communications may be monitored to ensure effective

> operation of the system and for other lawful purposes.

>

> Although we have endeavoured to ensure that this e mail and any

> attachments are free from any virus we would advise you to take any

> necessary steps to ensure that they are actually virus free.

> *****

> *****

>

Spence, Gillian

From: Spence, Gillian
Sent: 31 May 2016 12:20
To: Economic Growth and Development Services; Wilkinson, Sue
Subject: THE BOROUGH OF STOCKTON-ON-TEES GOOSE PASTURE, YARM TRAFFIC REGULATION ORDER 2016

This email was classified as : OFFICIAL

EGDS - Please could you send this out for me to receipt on. Thanks

with a 'delivery' and a 'read'

Sue – copy of reply to Goose Pasture TRO for your file, thanks. Gillian.

Dear Ms Beckwith

THE BOROUGH OF STOCKTON-ON-TEES GOOSE PASTURE, YARM TRAFFIC REGULATION ORDER 2016

Further to your formal objection to the above advertised draft traffic Order.

I would firstly like to provide you with some background information on how the proposals were developed before responding to your specific concerns and asking how you wish to proceed in this matter.

Residents of Goose Pasture reported that they regularly experienced inconsiderate parking causing an obstruction and that parking on the bend near No 1 and No 45/47 and also on the existing single yellow line on the bank, was a road safety and traffic management concern when leaving/accessing the residential area.

It was requested by residents that the Council give consideration to changing the single yellow line to double yellow and also to extending the yellow lines further to protect the bend from parking at all times. Since it would be feasible to amend the double yellow lining to cover the entire length, along both sides of Goose Pasture, that was also an option for residents to comment upon as part of a consultation that took place with all residents of Goose Pasture.

The consultation with residents had an excellent response rate at 93%. All respondents were in support of the proposal to change the single yellow line to double yellow and also that the lining is extended to protect the bend.

The majority (75%) of respondents along the southern fork of Goose Pasture, that is the area leading to Rookery Woods, also strongly supported the proposal to cover both sides of the road with restrictions to address any displaced parking arising from the extended and amended times of the restrictions causing parking issues further into that area. As part of the consultation process, Enforcement Team requested consideration was given to including loading restrictions with the changes to the yellow lining. This removes the requirement for 'observation time' and reduces Enforcement Officer time away from school gates where a presence is more desirable in the early morning and afternoon.

Therefore, the proposal taken forward was to include all comments received from the consultation and change the single yellow line to double yellow, extend the restrictions to protect the bend, extend the restrictions on both sides of the southern fork but to leave the area adjacent to number 49 at that residents' request and finally to include a Monday to Friday 8.30 – 9.30am and 2.30 – 4.30pm loading restriction to assist enforcement. Some residents also reported anti-social behaviour and environmental nuisance in, or near the Woods, which was causing distress and trouble for some residents in this vicinity. The restrictions

would also assist Enforcement in moving on vehicles parked on the lining who residents report may be acting suspiciously.

Moving on to your specific grounds for objection. Yellow lines will not be laid adjacent to number 49, this is following discussions with the resident who has had regular contact with the Council and has explained the issue surrounding the driveway. Goose Pasture is adopted highway and there are no rights to park, even outside of your own property furthermore the Council cannot reserve a space on adopted public highway for a specific property.

The area adjacent to number 49 would be unrestricted and may therefore be available for you to park. You may also park where restrictions are not laid elsewhere on Goose Pasture and also on a single yellow line if the waiting restriction does not apply. The lining on The Spital for example applies Monday to Friday between 8am to 9am and 4pm to 5pm and you could therefore legally park on a weekday between 9am and 4pm on those lines. I obviously do not know your personal circumstances but I should also make you aware that if you are a blue badge holder you may park on the double yellow lines for up to 3 hours, providing no obstruction is caused by doing so and therefore if this is applicable you may park on the lining when the loading restriction is not in operation.

The majority of residents in the street have requested that the advertised restrictions are implemented and all properties of Goose Pasture do have provision of a private driveway.

Given the above, the next stage is to ask you to please consider your objection, whether you wish to formally withdraw it, or uphold it. Should you wish your objection to stand, the item will be referred to the Council's Appeals and Complaints Committee. The Committee is independent to the Traffic Regulation Order process, as an objector you would be given every opportunity to address the Committee if you wish. I must make you aware that your correspondence will form part of the Appeals and Complaints Committee papers and it will therefore become a public document at that stage. The alternative is to formally withdraw your objection.

A reply by e-mail is acceptable to Legal Services using the following address sue.wilkinson@stockton.gov.uk I would be grateful if could you please indicate your intentions by 15 June 2016.

Thank you for your assistance.

Regards,
Gillian.

Gillian Spence
Engineer – Network Safety
Economic Growth and Development

-----Original Message-----

From: swan:
Sent: 17 May 2016 20:02
To: Wilkinson, Sue
Subject: Double yellow lines - Christine Beckwith

Hi my friend lives in 49 goose pastures and as done for 20 years , her drive is not suitable to park on so when visiting her they will be no where to park if yellow lines go down she as never had a problem before and if they leave lines off outside her house other people will park there.

Kind regards Christine Beckwith
Sent from my iPhone

5.28 DONNA CALDICOTT

Spence, Gillian

From: Wilkinson, Sue
Sent: 14 June 2016 09:59
To: Spence, Gillian
Subject: FW: Goose pasture - Donna Caldicott

This email was classified as : OFFICIAL

Hi Gillian

Please see below email.

Thanks

Sue

Please note that my working days are Tuesdays, Wednesdays and Fridays.

-----Original Message-----

From: donna caldicott
Sent: 13 June 2016 10:13
To: Wilkinson, Sue
Subject: Goose pasture

Hi Sue would like to uphold my objection to parking restrictions on road in cul de sac

Spence, Gillian

From: Spence, Gillian
Sent: 31 May 2016 12:18
To: Economic Growth and Development Services; Wilkinson, Sue
Subject: THE BOROUGH OF STOCKTON-ON-TEES GOOSE PASTURE, YARM TRAFFIC REGULATION ORDER 2016

This email was classified as : OFFICIAL.

EGDS - Please could you send this out for me to _____ with a 'delivery' and a 'read' receipt on. Thanks

Sue – copy of reply to Goose Pasture TRO for your file, thanks.
Gillian.

Dear Ms Caldicott

THE BOROUGH OF STOCKTON-ON-TEES GOOSE PASTURE, YARM TRAFFIC REGULATION ORDER 2016

Further to your formal objection to the above advertised draft traffic Order.

I would firstly like to provide you with some background information on how the proposals were developed before responding to your specific concerns and asking how you wish to proceed in this matter.

Residents of Goose Pasture reported that they regularly experienced inconsiderate parking causing an obstruction and that parking on the bend near No 1 and No 45/47 and also on the existing single yellow line on the bank, was a road safety and traffic management concern when leaving/accessing the residential area.

It was requested by residents that the Council give consideration to changing the single yellow line to double yellow and also to extending the yellow lines further to protect the bend from parking at all times. Since it would be feasible to amend the double yellow lining to cover the entire length, along both sides of Goose Pasture, that was also an option for residents to comment upon as part of a consultation that took place with all residents of Goose Pasture.

The consultation with residents had an excellent response rate at 93%. All respondents were in support of the proposal to change the single yellow line to double yellow and also that the lining is extended to protect the bend.

The majority (75%) of respondents along the southern fork of Goose Pasture, that is the area leading to Rookery Woods, also strongly supported the proposal to cover both sides of the road with restrictions to address any displaced parking arising from the extended and amended times of the restrictions causing parking issues further into that area. As part of the consultation process, Enforcement Team requested consideration was given to including loading restrictions with the changes to the yellow lining. This removes the requirement for 'observation time' and reduces Enforcement Officer time away from school gates where a presence is more desirable in the early morning and afternoon.

Therefore, the proposal taken forward was to include all comments received from the consultation and change the single yellow line to double yellow, extend the restrictions to protect the bend, extend the restriction on both sides of the southern fork but to leave the area adjacent to number 49 at that residents' request and finally to include a Monday to Friday 8.30 – 9.30am and 2.30 – 4.30pm loading restriction to assist enforcement. Some residents also reported anti-social behaviour and environmental nuisance in, or near the Woods, which was causing distress and trouble for some residents in this vicinity. The restrictions

would assist Enforcement in moving on vehicles parked on the lining who residents report may be acting suspiciously.

Moving on to your specific grounds for objection. It is acceptable to load/unload equipment from your vehicle into the property by parking on the double yellow lines, therefore you could park on the lining, as long as it is outside the times when the loading restriction applies for this purpose. Once loading activity has finished you would then need to park up elsewhere, this can be on any part of the highway where restrictions have not been laid as long as it would not cause an obstruction, note there are some areas on Goose Pasture which will remain unrestricted. You may also choose to park on the private driveway where you work, or on a single yellow line if the waiting restriction does not apply, such as on The Spital where the lining applies Monday to Friday between 8am to 9am and 4pm to 5pm and you could therefore legally park on a weekday between 9am and 4pm on those lines.

I hope this response has provided you with the background to the proposals and also explained that you can park on the proposed restrictions to load/unload equipment at certain times near to your workplace. You would then need to park up during your hours of work elsewhere but this could be on Goose Pasture where restrictions are not laid, or on The Spital between 9am and 4pm, which I hope you will agree are both within walking distance to your workplace.

Given the above, the next stage is to ask you to please consider your objection, whether you wish to formally withdraw it, or uphold it. Should you wish your objection to stand, the item will be referred to the Council's Appeals and Complaints Committee. The Committee is independent to the Traffic Regulation Order process, as an objector you would be given every opportunity to address the Committee if you wish. I must make you aware that your correspondence will form part of the Appeals and Complaints Committee papers and it will therefore become a public document at that stage. The alternative is to formally withdraw your objection.

A reply by e-mail is acceptable to Legal Services using the following address sue.wilkinson@stockton.gov.uk I would be grateful if could you please indicate your intentions by 15 June 2016.

Thank you for your assistance.

Regards,

Gillian.

Gillian Spence
Engineer – Network Safety
Economic Growth and Development

-----Original Message-----

From: donna caldicott
Sent: 17 May 2016 11:14
To: Wilkinson, Sue
Subject: Goose pasture road marking

Hi i have been sent this email about the proposed markings outside a house i currently clean once a week i am objecting to the markings as i need to park my car outside her house to get my equipment out

Sent from my iPhone

5.31 MR LEACH

1 The Pines,
Yarm
Stockton-on-Tees
TS15 9EW

Date: 13 May 2016

Dear Mr Bond,

Subject: Proposed waiting restrictions, Goose Pastures, YARM.

The proposed waiting restrictions to be applied to 'Goose Pastures' and already in place on 'The Spital' relate to the parking of vehicles, including coaches, associated with the Grammar school. We have noted recently that more vehicles are taking note of the existing restrictions and, as a consequence, now park further up 'The Spital'. A consequence of this is a developing serious hazard to vehicles attempting to exit 'The Pines', particularly at peak school times. Further, we have noted that more vehicles are parking on the road and pavements of 'The Pines', often for extended periods and a consequence of this is difficulty in being able to access/leave our own driveways. There have also been instances in the past year where parked vehicles have caused such restrictions that other vehicles have had to reverse into 'The Spital' and across two lanes of stationary vehicles to allow others to exit 'The Pines'. I can envisage this situation deteriorating further with these new proposed parking restrictions and the ever increasing traffic/parking problems when entering Yarm 'High Street'.

A suggestion would be to install permanent 'Parking for residents only' signs at the entrance to 'The Pines'. I ask you to consider this proposal in conjunction with specific line marking restrictions local to the junction with 'The Spital' to improve safety local to the junction.

Yours sincerely,

Mr M C Leach

Green Lact. No 3.

Stacy Dery No 7

W. T. N

SOUTHERN MOUNT.

Walker - LISA WALKER No 2.

K. WORTHINGTON No 5 -

J. R. M. No 4

Conliffe - No 6.



My Ref: TS.T.15.1
Email: EGDS@stockton.gov.uk

PO Box 229, Kingsway House,
West Precinct, Billingham
TS23 2YL
Tel: (01642) 526709
Fax: (01642) 526713
DX 60611
Postcode for Sat Nav purposes:
TS23 2NX

31 May 2016

Dear Mr Leach

THE BOROUGH OF STOCKTON ON TEES GOOSE PASTURE, YARM TRAFFIC REGULATION ORDER 2016

Further to your letter to Legal Services with regard to the above advertised traffic Order. I would firstly like to give you some background information on how the proposals for Goose Pasture were developed before responding to your specific concerns and asking how you wish to proceed.

Background Information – Goose Pasture proposals

The proposals, which are now at Statutory consultation, originate from residents of Goose Pasture reporting that they regularly experienced inconsiderate parking causing an obstruction and that parking on the bend near No 1 and No 45/47 and also on the existing single yellow line on the bank, was a road safety and traffic management concern when leaving/accessing the residential area.

It was requested by residents that the Council give consideration to changing the single yellow line to double yellow and also to extending the yellow lines further to protect the bend from parking at all times. This type of change involves processing a traffic Order, which is a lengthy legal process during which a Statutory objection period is observed (this is the part to which you have responded). Requests for traffic Orders cannot be dealt with immediately because of limited funding and resources available to the Council, they are therefore added to a list of similar requests and scored on a matrix against factors that rate it's benefits to traffic management and road safety. Goose Pasture was added to that list awaiting prioritisation although it was not identified as an immediate priority. Therefore local residents approached the local Ward Councillors to ask for their assistance in funding the traffic Order from their annual Ward budget. Ward Councillors agreed, subject to the proposals receiving an appropriate level of support from affected residents.

A consultation then took place with all residents of Goose Pasture. The consultation had an excellent response rate at 93%. All respondents were in support of the proposal to change the single yellow line to double yellow and also that the lining is extended to protect the bend.

Cont'd.....

Mr M.C. Leach
1 The Pines
Yarm
Stockton-on-Tees
TS15 9EW.

The majority (75%) of respondents specifically along the southern fork of Goose Pasture, that is the area leading to Rookery Woods, also strongly supported the proposal to cover both sides of the road with restrictions to address any displaced parking arising from the extended and amended times of the restrictions causing parking issues further into that area.

Moving on to your specific queries at The Pines which I note to be:

Residents Parking request

The Council also receives too many requests for residents permit parking to be dealt with immediately and requests are initially assessed against criteria in order to allocate funds to the areas which will benefit most from them. The criteria states residents parking schemes will not be prepared for individual streets, but for areas with clear boundaries in which parking by commuters is identified, through traffic surveys, as having a significant impact upon the availability of on street parking for local residents.

Areas that meet the criteria are then added to a list awaiting further investigation.

Goose Pasture and The Pines do not meet the assessment criteria because the problems are associated with obstruction and inconsiderate parking rather than residents actually being unable to park relatively near to their property, since all properties on Goose Pasture and The Pines do have private, off street facilities.

Residents parking schemes are also not appropriate for areas adjacent to schools to deal with school time traffic issues given the very limited times when those issues occur, which tend to be during term time on week days. Existing schemes across the Borough operate for most of the day to address long stay commuter parking and make spaces available for permit holders to enable residents to park near their property. Unfortunately, for the reasons I have outlined, The Pines is not appropriate for residents permit parking.

Obstructive parking

In response to your reports of regular obstruction to driveways, it would be practicable to install a white 'H' marking across driveways, with residents' agreement. The marking itself would be a single white line, it advises motorists that it is a part of the carriageway which should be kept clear of parked vehicles and could be laid fairly promptly. This marking has been successful in discouraging inconsiderate and obstructive parking at other locations in the Borough. It is not backed by a traffic Order, however, parking on it can be enforced.

I should advise that residents and their visitors could be issued with a parking notice if their vehicles are parked on the marking because it is not practical for Enforcement Officers to check with householders prior to enforcement action. Therefore if you agree this would be acceptable, residents would all be consulted directly and be required to acknowledge this via completing a slip accepting the terms on which the marking is to be laid.

Cont'd.....

Request for waiting restrictions

With regard to your query if The Pines could have waiting restrictions, double yellow lines, implemented around the junction with The Spital. That would be subject to a traffic Order, as per previously described and the request would need to be added to the list awaiting priority. I expect the request to score similarly to the Goose Pasture original request and that would mean it would not be a priority for progression at this time. Unfortunately, it is too late to add The Pines into the Goose Pasture Order because that Statutory consultation has already been carried out. However, again I propose that a white 'H' marking could be laid fairly promptly to cover the junction plus 10 metres back into The Pines if you consider that would be a suitable alternative to yellow lining.

I have enclosed a leaflet regarding obstructive parking and the actions the Council can reasonably take in response which I hope you will find informative.

Next steps

Given the above, the next stage is to ask you to please consider your letter, whether you wish it to be considered as a formal objection to the advertised proposals on Goose Pasture. Should you wish your letter to be regarded as a formal objection, the advertised proposals will not be progressed and the item will be referred to the Council's Appeals and Complaints Committee. The Committee is independent to the Traffic Order process, as an objector you would be given every opportunity to address the Committee if you wish. I must make you aware that your correspondence will form part of the Appeals and Complaints Committee papers and it will therefore become a public document at that stage. The alternative is not to record your letter as an objection and progress The Pines as a separate matter, starting by consulting residents on the 'H' markings proposal.

I would be grateful if could you please indicate your intentions by 15 June 2016, by completing the attached reply slip and returning it in the enclosed pre-paid envelope. I trust you will update the counter signatories to your letter.

Yours sincerely,

Anthony Wilton
Principal Engineer – Network Safety
Economic Growth and Development Services

Encl; leaflet, reply slip, envelope.

Copy: Sue Wilkinson, Legal Services, Municipal Buildings.



To: Principal Engineer – Network Safety
Stockton-on-Tees Borough Council
PO Box 229
1st Floor Kingsway House
West Precinct
Billingham
TS23 2YL.

Ref: TS/T/15/1

**THE BOROUGH OF STOCKTON ON TEES GOOSE PASTURE, YARM TRAFFIC
REGULATION ORDER 2016**

With reference to my letter regarding the above draft Order.

I wish my representation to be considered as a formal objection
to be heard by the Council's Appeals and Complaints Committee YES / NO *

I wish to withdraw my representation YES / NO*

(* Please delete as appropriate).

From:

Address:
.....
.....
.....

Postcode:

Date:

Please return reply slip by 15 June 2016.
Thank you for your response

GSpence.